

杭州柏全机电有限公司

HANGZHOU BAIQUAN ELECTROMECHANICAL CO., LTD.



地址：杭州市萧山经济技术开发区春潮路100号

电话：0086 13588175767

邮件：sales@cnspeedway.com

网站：www.cnspeedway.en.alibaba.com www.buyall.en.alibaba.com

The PTO drive shaft for agricultural applications consists of two cardan joints and a telescopic coupling. The cardan joint, consisting of two yokes and a cross, is the element used to transmit the motion between two tilted axles. The cardan joint construction is designed so that during rotation, the speed of the output shaft is not always equal to that of the input shaft and this difference in speed depends on the articulation angle of the joint (Fig.1). The transmission ratio versus the articulation angle and the rotation angle is represented in Fig. 2. The more the ratio deviates from 1 the greater becomes the irregularity of the motion, thus generating undesirable effects (vibrations, noise, inertial stress).

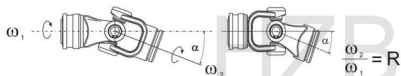

Fig.1

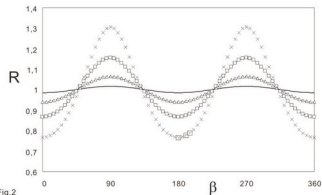

Fig.2

Instantaneous transmission ratio
 α = articulation angle β = rotation angle

The standard PTO drive shaft consists of two cardan joints. The irregularities of the single joints thus can be cancelled or mutually combined. When the articulation angles of the two joints are equal (see configuration W or Z in Fig.3) the transmission is uniform, i.e. The speed of the output yoke is always equal to the speed of the input yoke, thus eliminating the undesirable effects. In all the other configurations (Fig.4), an irregularity always remains that can be evaluated with the graph on the following page (Fig.5).

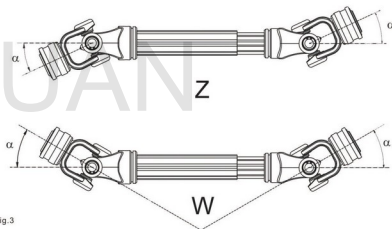

Fig.3

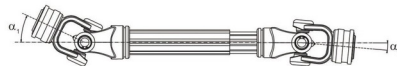
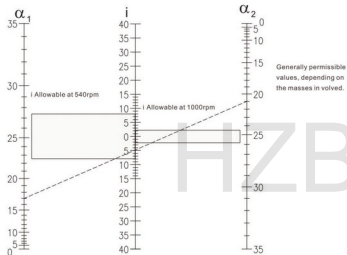

Fig.4

Irregularity "i" of the motion depends on the articulation of the two cardan joints and on the difference between the articulations of the two joints (see the example: with angular difference being equal, the irregularity is greater if the articulations of the single joints are greater).



PTO drive shaft rotation irregularity alignment chart

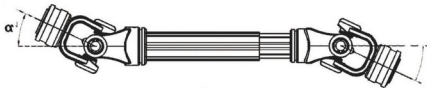

Fig.5

Example:
 $\alpha_1 = 0^\circ, \alpha_2 = 4^\circ, \alpha_1 - \alpha_2 = 4^\circ$
 $i = 0.5\%$
 $\alpha_1 = 21^\circ, \alpha_2 = 25^\circ, \alpha_1 - \alpha_2 = 4^\circ, i = 6\%$

The CVJ (Constant Velocity Joint) is a double universal joint with a centering system that equally divides the articulation angle between the two yokes (W configuration). The speed of the output yoke is always equal to the input speed and there are no rotation irregularities. In a PTO drive shaft with a CVJ joint and a standard joint (Fig.6), the total irregularity is caused only by the standard joint, that therefore must work with small articulation angles. For high work angles at the two ends of the shaft, two CVJ joints must be used (Fig.7). The CVJ joint can work with high articulation angles only for brief periods (ex.: while steering). Absolute quality and reliability of the CVJ construction are ensured by the ball bridge welded to the yoke which considerably reduces stress and consequently wears in the ball-cylinder contact zone and in the splined coupling between the shaft and the yoke.

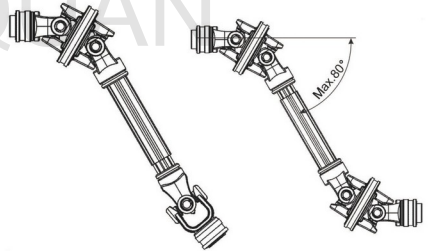
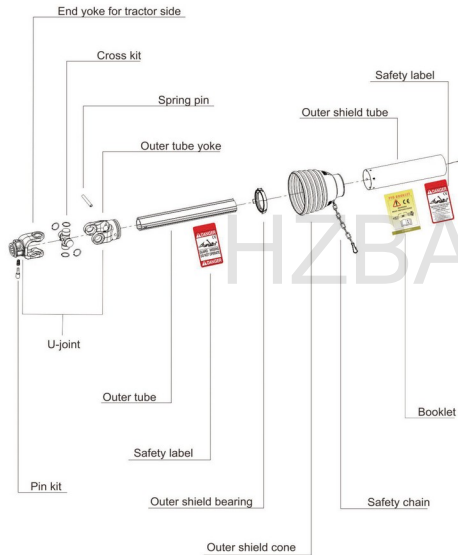

Fig.6

Fig.7

THE STRUCTURE OF PTO SHAFT



THE STRUCTURE OF PTO SHAFT

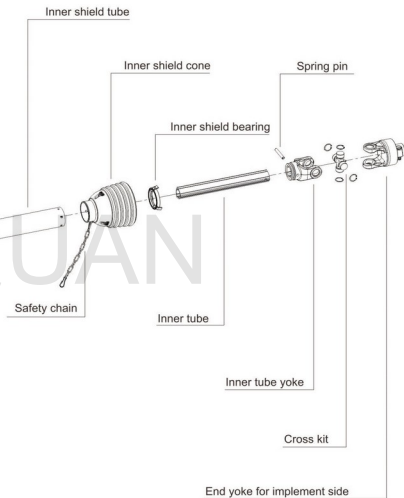

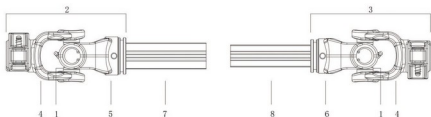

Series	Cross	Joint simple		Spined yoke	Tube yoke		Tube	
		Outer	Inner		Outer	Inner	Outer	Inner
	1	2	3	4	5	6	7	8
T1	1.01 (22*54)	1.0505B+1.01 +1.06	1.0505B+1.01 +1.07	1.0505B	1.06	1.07	1.03	1.04
T2	2.01 (23.8*61.3)	2.0505B+2.01 +2.06	2.0505B+2.01 +2.07	2.0505B	2.06	2.07	2.03	2.04
T3	3.01 (27*70)	3.0505B+3.01 +3.06	3.0505B+3.01 +3.07	3.0505B	3.06	3.07	3.03	3.04
T4	4.01 (27*74.6)	4.0505B+4.01 +4.06	4.0505B+4.01 +4.07	4.0505B	4.06	4.07	4.03	4.04
T5	5.01 (30.2*80)	5.0505B+5.01 +5.06	5.0505B+5.01 +5.07	5.0505B	5.06	5.07	5.03	5.04
T6	6.01 (30.2*92)	6.0505B+6.01 +6.06	6.0505B+6.01 +6.07	6.0505B	6.06	6.07	6.03	6.04
T7	7.01 (30.2*106.5)	7.0505B+7.01 +7.06	7.0505B+7.01 +7.07	7.0505B	7.06	7.07	7.03	7.04
T7N	7N.01 (35*94)	7N.0505B+7N.01 +7N.06	7N.0505B+7N.01 +7N.07	7N.0505B	7N.06	7N.07	7N.03	7N.04
T8	8.01 (35*106.5)	8.0505B+8.01 +8.06	8.0505B+8.01 +8.07	8.0505B	8.06	8.07	8.03	8.04
T38	38.01 (38*105.6)	38.0505B+38.01 +38.06	38.0505B+38.01 +38.07	38.0505B	38.06	38.07	38.03	38.04
T9	9.01 (41*108)	9.0505B+9.01 +9.06	9.0505B+9.01 +9.07	9.0505B	9.06	9.07	9.03	9.04
T10	10.01 (41*118)	10.0505B+10.01 +10.06	10.0505B+10.01 +10.07	10.0505B	10.06	10.07	10.03	10.04

PRODUCT INTRODUCTION



Series	Operating torque						
	540tr./min			1000tr./min			MP (NM)
	Kw	Pk	Nm	Kw	Pk	Nm	
T1	12	16	210	18	25	172	320
T2	15	21	270	23	31	220	450
T3	22	30	390	35	47	330	640
T4	26	35	460	40	55	380	780
T5	35	47	620	54	74	520	1050
T6	47	64	830	74	100	710	1450
T7	55	75	970	87	118	830	1800
T7N	55	75	970	87	118	830	1800
T8	70	95	1240	110	150	1050	2250
T38	78	105	1380	123	166	1175	2500
T9	88	120	1560	140	190	1340	2800
T10	106	145	1905	170	230	1650	3500

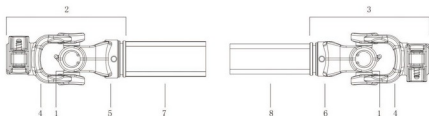

Series	Cross	Joint simple		Splined yoke	Tube yoke		Tube	
		Outer	Inner		Outer	Inner	Outer	Inner
	1	2	3	4	5	6	7	8
L1	1.01 (22*54)	1.0505B+1.01 +1.06L	1.0505B+1.01 +1.07L	1.0505B	1.06L	1.07L	1.03L	1.04L
L2	2.01 (23.8*61.3)	2.0505B+2.01 +2.06L	2.0505B+2.01 +2.07L	2.0505B	2.06L	2.07L		
L3	3.01 (27*70)	3.0505B+3.01 +3.06L	3.0505B+3.01 +2.07L	3.0505B	3.06L	3.07L	4.03L	4.04L
L4	4.01 (27*74.6)	4.0505B+4.01 +4.06L	4.0505B+4.01 +4.07L	4.0505B	4.06L	4.07L		
L5	5.01 (30.2*80)	5.0505B+5.01 +5.06L	5.0505B+5.01 +5.07L	5.0505B	5.06L	5.07L		
L6	6.01 (30.2*92)	6.0505B+6.01 +6.06L	6.0505B+6.01 +6.07L	6.0505B	6.06L	6.07L	6.03L	6.04L
L32	32.01 (32*76)	32.0505B+32.01 +32.06L	32.0505B+32.01 +32.07L	32.0505B	32.06L	32.07L		

PRODUCT INTRODUCTION



Series	Operating torque						
	540tr./min			1000tr./min			MP (NM)
Kw	Pk	Nm	Kw	Pk	Nm		
L1	12	16	210	18	25	172	320
L2	15	21	270	23	31	220	450
L3	22	30	390	35	47	330	640
L4	26	35	460	40	55	380	780
L5	35	47	970	54	74	520	1050
L6	47	64	830	74	100	710	1450
L32	39	53	695	61	83	580	1200

PTO DRIVESHAFT S SERIES

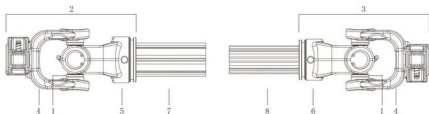

Series	Cross	Joint simple		Splined yoke	Tube yoke		Tube	
		Outer	Inner		Outer	Inner	Outer	Inner
	1	2	3	4	5	6	7	8
S6	6.01 (30.2*92)	6.0505B+6.01 +6.06S	6.0505B+6.01 +6.07S	6.0505B	6.06S	6.07S		
S7	7.01 (30.2*106.5)	7.0505B+7.01 +7.06S	7.0505B+7.01 +7.07S	7.0505B	7.06S	7.07S		
S8	8.01 (35*106.5)	8.0505B+8.01 +8.06S	8.0505B+8.01 +8.07S	8.0505B	8.06S	8.07S	6.03ST	6.04ST
S38	38.0 (38*105.6)	38.0505B+38.01 +38.06S	38.0505B+38.01 +38.07S	38.0505B	38.06S	38.07S		
S32	2400 (32*76)	32.0505B+32.01 +32.06S	32.0505B+32.01 +32.07S	32.0505B	32.06S	32.07S		
S36	2500 (36*89)	36.0505B+36.01 +36.06S	36.0505B+36.01 +36.07S	36.0505B	36.06S	36.07S		
S9	9.01 (41*108)	9.0505B+9.01 +9.06S	9.0505B+9.01 +9.07S	9.0505B	9.06S	9.07S		
S10	10.01 (41*118)	10.0505B+10.01 +10.06S	10.0505B+10.01 +10.07S	10.0505B	10.06S	10.07S		
S42	2600 (42*104.5)	42.0505B+42.01 +42.06S	42.0505B+42.01 +42.07S	42.0505B	42.06S	42.07S	10.03ST	10.04ST
S48	48.01 (48*127)	48.0505B+48.01 +48.06S	48.0505B+48.01 +48.07S	48.0505B	48.06S	48.07S		
S50	50.01 (50*118)	50.0505B+50.01 +50.06S	50.0505B+50.01 +50.07S	50.0505B	50.06S	50.07S		

PTO DRIVESHAFT S SERIES

PRODUCT INTRODUCTION



Series	Operating torque						
	540tr./min			1000tr./min			MP (NM)
	Kw	Pk	Nm	Kw	Pk	Nm	
S6	47	64	830	74	100	710	1450
S7	55	75	970	87	118	830	1800
S8	70	95	1240	110	150	1050	2250
S38	78	105	1380	123	166	1175	2500
S32	39	53	695	61	83	580	1200
S36	66	90	1175	102	139	975	2000
S9	88	120	1560	140	190	1340	2800
S10	106	145	1905	170	230	1650	3500
S42	79	107	1400	122	166	1175	2500
S48	133	180	2390	205	277	1958	4200
S50	119	162	2095	182	248	1740	3700

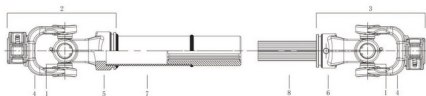

Series	Cross	Joint simple		Splined yoke	Tube yoke		Tube	
		Outer	Inner		Outer	Inner	Outer	Inner
	1	2	3	4	5	6	7	8
G2	2.01 (23.8*61.3)	2.0505B+2.01 +2.06G	2.0505B+2.01 +2.07G	2.0505B	2.06G	2.07G	50X2.5	G35-18
G4	4.01 (27*74.6)	4.0505B+4.01 +4.06G	4.0505B+4.01 +4.07G	4.0505B	4.06G	4.07G	50X2.5	G35-18
G5	5.01 (30.2*80)	5.0505B+5.01 +5.06G	5.0505B+5.01 +5.07G	5.0505B	5.06G	5.07G		
G6	6.01 (30.2*92)	6.0505B+6.01 +6.06G	6.0505B+6.01 +6.07G	6.0505B	6.06G	6.07G	60X3	G40-14
G7	7.01 (30.2*106.5)	7.0505B+7.01 +7.06G	7.0505B+7.01 +7.07G	7.0505B	7.06G	7.07G		
G8	8.01 (35*106.5)	8.0505B+8.01 +8.06G	8.0505B+8.01 +8.07G	8.0505B	8.06G	8.07G		
G38	38.01 (38*105.6)	38.0505B+38.01 +38.06G	38.0505B+38.01 +38.07G	38.0505B	38.06G	38.07G	65X3.5	G45-16
G42	2600 (42*104.5)	42.0505B+42.01 +42.06G	42.0505B+42.01 +42.07G	42.0505B	42.06G	42.07G		
G50	50.01 (50*118)	50.0505B+50.01 +50.06G	50.0505B+50.01 +50.07G	50.0505B	50.06G	50.07G	75X4	G55-20



Series	Operating torque						MP (NM)
	540tr./min			1000tr./min			
	Kw	Pk	Nm	Kw	Pk	Nm	
G2	15	21	270	23	31	220	450
G4	26	35	460	40	55	380	780
G5	35	47	620	54	74	520	1050
G6	47	64	830	74	100	710	1450
G7	55	75	970	87	118	830	1800
G8	70	95	1240	110	150	1050	2250
G38	78	105	1380	123	166	1175	2500
G42	79	107	1400	122	166	1175	2500
G50	119	162	2095	182	248	1740	3700

CROSS KIT

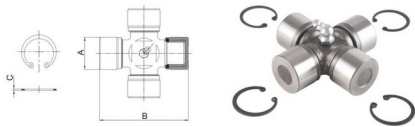

Series	A(mm)	B(mm)	C(mm)
1.01	22	54	1.2
2.01	23.8	61.3	1.2
3.01	27	70	1.2
4.01	27	74.6	1.2
5.01	30.2	80	1.5
32.01	32	76	1.5
6.01	30.2	92	1.5
7.01	30.2	106.5	1.5
7N.01	35	94	1.5
8.01	35	106.5	1.5
38.01	38	105.6	1.5
36.01	36	89	1.5
9.01	41	108	1.75
10.01	41	118	1.75
42.01	42	104.5	1.75
48.01	48	127	1.75
50.01	50	118	2

CROSS KIT

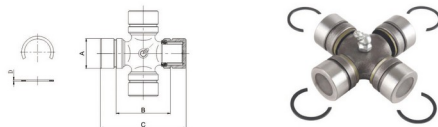

Series	A(mm)	B(mm)	C(mm)	D(mm)
JH32.01	32	57	92	1.5
JH38.01	38	57	101	3

HZBAIQUAN

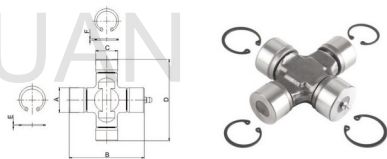

Series	A(mm)	B(mm)	C(mm)	D(mm)	E(mm)	F(mm)
2WA.01	23.8	61.3	22	76	1.2	1.2
4WA.01	27	74.6	23.8	91	1.2	1.2
6WA.01	30.2	92	27	100	1.5	1.2
8WA.01	35	106.5	30.2	106	1.5	1.5
32WA.01	32	76	27	94	1.5	1.2
36WA.01	36	89	32	106	1.5	1.5
42WA.01	42	104.5	36	124	1.75	1.5

TUBE

TRIANGULAR TUBE



Series	Cross Kit	Outer	Inner
1	T1 #27	1.03 	1.04
2	T2 #23.9	2.03 	2.04
3	T3 #27	3.03 	3.04
4	T4 #27	4.03 	4.04
5	T5 #30.2	5.03 	5.04
6	T6 #30.2	6.03 	6.04
7	T7 #30.2	7.03 	7.04
8	T8 #35	8.03 	8.04
9	T9 #41	9.03 	9.04

TUBE

LEMON TUBE



Series	Cross Kit	Outer	Inner
1	#22	1.03L 	1.04L
2	#23.9	2.03L 	2.04L
3	#27	3.03L 	3.04L
4	#27	4.03L 	4.04L
5	#30.2	5.03L 	7.04L
6	#30.2	6.03L 	6.04L
32	#32	32.03L 	32.04L

TUBE

STAR TUBE



Series	Cross Kit	Outer	Inner
6		 6.03ST	 6.04ST
7			
7N			
8			
36			
38			
9			
10			
42			
50			

TUBE

GEAR TUBE



Series	Cross Kit		
2		2.04G	 Z17(16-1)M1.75 x 30°
3		3.04G	
4		4.04G	
5		5.04G	 Z13(14-1)M2.65 x 30°
6		6.04G	
7		7.04G	 Z19(16-1)M2.5 x 30°
7N		7N.04G	
8		8.04G	
36		36.04G	
38		38.04G	
9		9.04G	
10		10.04G	
42		42.04G	
48		48.04G	
50		50.04G	

RECTANGULAR TUBE



Series	Cross Kit	Outer	Inner
1		1.03R 	1.04R
2		2.03R 	2.04R
3		3.03R	3.04R
4		4.03R	4.04R
5		5.03R 	5.04R
6		6.03R	6.04R
32		32.03R	32.04R

HEXAGONAL TUBE



Series	Cross Kit	Outer	Inner
40HP		HT.03T1 	HT.04T1
50HP			
80HP		HT.03 	HT.04
90HP			

SAFTY SHIELD

SHIELD I



Series	Tube(A)		Retaining collar(B)		Color
	Inner	Outer	Inner	Outer	
1	48.5	54	34	40	BII:Black YII:Yellow
2	61	66.5	40	47	
3/4	61	66.5	46	53	
5	75	81	54	62	
6/7/8	75	81	59.5	68.5	
42/48/50	90	96	69.5	81.5	

SHIELD II



Series	Tube(A)		Retaining collar(B)		Color
	Inner	Outer	Inner	Outer	
1	48.5	54	34	40	BII:Black YII:Yellow YBII:Yellow+Black
2	61	66.5	40	47	
3/4	61	66.5	46	53	
5	75	81	54	62	
6/7/8	75	81	59.5	68.5	
42/48/50	90	96	69.5	81.5	

SAFTY SHIELD

SHIELD III

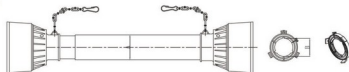

Series	Tube(A)		Retaining collar(B)		Color
	Inner	Outer	Inner	Outer	
1	48.5	54	34	40	BII:Black YII:Yellow
2	61	66.5	40	47	
3/4	61	66.5	46	53	
5	75	81	54	62	
6/7/8	75	81	59.5	68.5	
42/48/50	90	96	69.5	81.5	

SHIELD WA

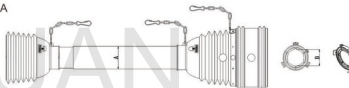

Series	Tube(A)		Retaining collar(B) Wide Angle Shield				Color
	Inner	Outer	Inner	Outer	C	D	
4	61	66.5	46	53	117	210	BWA:Black YWA:Yellow YBWA:Yellow+Black
6/32/36	75	81	59.5	68.5	123	225	
8	75	81	62.5	72.5	127	245	

SHIELD N

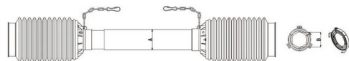

Series	Tube(A)		Retaining collar(B)		Color
	Inner	Outer	Inner	Outer	
1	48.5	54	34	40	BN:Black YN:Yellow
2	61	66.5	40	47	
3/4	61	66.5	46	53	
5	75	81	54	62	
6/7/8	75	81	59.5	68.5	
42	90	96	69.5	81.5	

PUSH PIN & TAPER PIN

Reference	L(mm)	Drawings
00.0201×47	47	
00.0201×44.5	44.5	
00.0201×59	59	
00.0201×56	56	
00.0202×76.5	76.5	
00.0202×68	68	
00.0202×73	73	
00.0202×83	83	
00.0202×85	85	
00.0202×88	88	
00.0203×85	85	
00.0204×69	69	
00.0205×43	43	
00.0206×54	54	
00.0207×85	85	
00.0208×85	85	
00.0208×77	77	
00.0209×91	91	
00.0210×77	77	
00.0210×75	75	

SPRING PIN&SAFETY CHAINS

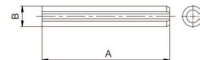

For Tube	A(mm)	B(mm)
1.04	45	Φ8
2.04	50	
3.04	55	
4.04	55	
5.04	65	Φ10
6.04	70	
7.04	70	
8.04	90	

For Tube	A(mm)	B(mm)
1.03	50	Φ8
2.03	55	
3.03	60	
4.03	60	
5.03	70	Φ10
6.03	75	
7.03	75	
8.03	90	

SAFETY CHAINS

Golden Safety Chains

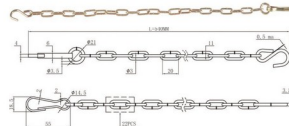

Silvery Safety Chains

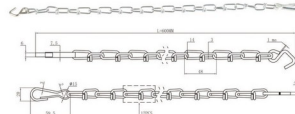

CODE EXPLANATION

For example

T	-	4	-	YB	-	II	-	P	-	4.0505B	-	4FFV1	*	L
↓		↓		↓		↓		↓		↓		↓		↓
1		2		3		4		5		6		7		8



- 1: The Types of Tubes(e.g.: T, L;ST,G)
- 2: The Series of Cross Kits
- 3: The Code of Color (YB=Yellow+Black)
- 4: The Code of Safety Shield Structure
- 5: Connection Method: Pin Connected
- 6: The Tractor End Yokes
- 7: The Implement End Yokes
- 8: Minimum Overall Length

CODE FOR U-JOINT

For example

4.0501B	+	4.01	+	4.06
↓		↓		↓
1		2		3

- 1: One end yoke
- 2: The series of cross kits
- 3: The other end yoke



4.0501B+4.01+4.06

YOKE

TUBE AND SPLINED YOKE

OUTER TUBE YOKE-06 INNER TUBE YOKE-07	
OUTER TUBE YOKE-06L INNER TUBE YOKE-07L	
OUTER TUBE YOKE-06ST INNER TUBE YOKE-07ST	
SPLINED YOKE 01 -PUSH PIN	
SPLINED YOKE 02 -INTERFERING BOLT	
SPLINED YOKE 03 -NON-INTERFERING BOLT	
SPLINED YOKE 04 -BALL ATTACHMENT	
SPLINED YOKE 05 -PUSH PIN	
SPLINED YOKE 07 -PUSH PIN	
SPLINED YOKE 08-PUSH PIN	
SPLINED YOKE 11 -DOUBLE PUSH PIN	
SPLINED YOKE 13 -COLLAR	

PLAIN BORE YOKE

PLAIN BORE YOKE A -PIN HOLE	
PLAIN BORE YOKE B -KEYWAY	
PLAIN BORE YOKE C -KEYWAY & THREADED HOLE	
PLAIN BORE YOKE D -KEYWAY & CLAMP BOLT	
PLAIN BORE YOKE E -MULTIPLE PIN HOLES	
PLAIN BORE YOKE F -VERTICAL PIN HOLE	
PLAIN BORE YOKE H -PIN HOLE & THREADED HOLE	
ROUND HOLE YOKE -FOUR CORNER	

YOKE

TRIANGULAR YOKE

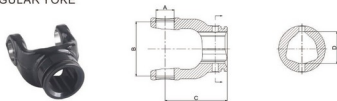

Series	A(mm)	B(mm)	C(mm)	D(mm)
1.06	22	54	77	32.4
1.07	22	54	77	26.6
2.06	23.8	61.3	82	36.1
2.07	23.8	61.3	82	29
3.06	27	70	90	43.4
3.07	27	70	90	36.1
4.06	27	74.6	90	43.4
4.07	27	74.6	90	36.1
5.06	30.2	80	98	51.3
5.07	30.2	80	98	44.7
32.06	32	76	98	51.3
32.07	32	76	98	44.7
6.06	30.2	92	104	53.6
6.07	30.2	92	104	44.7
7.06	30.2	106.5	117	53.6
7.07	30.2	106.5	117	44.7
7N.06	35	94	106	53.6
7N.07	35	94	106	44.7
36.06	36	89	106	53.6
36.07	36	89	106	44.7
8.06	35	106.5	121	62.7
8.07	35	106.5	121	53.6
38.06	38	105.6	121	62.7
38.07	38	105.6	121	53.6
9.06	41	108	130	62.7
9.07	41	108	130	53.6
10.06	41	118	125	62.7
10.07	41	118	125	53.6

YOKE

LEMON YOKE

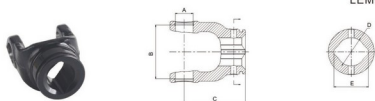

Series	A(mm)	B(mm)	C(mm)	D(mm)	E(mm)
1.06L	22	54	77	30	39
1.07L	22	54	77	23.7	30.8
2.06L	23.8	61.3	82	41.2	48
2.07L	23.8	61.3	82	34.5	40.1
3.06L	27	70	90	41.2	48
3.07L	27	70	90	34.5	40.1
4.06L	27	74.6	90	41.2	48
4.07L	27	74.6	90	34.5	40.1
5.06L	30.2	80	98	48	57.5
5.07L	30.2	80	98	39.5	49
32.06L	32	76	98	48	57.5
32.07L	32	76	98	39.5	49
6.06L	30.2	92	104	48	57.5
6.07L	30.2	92	104	39.5	49
7N.06L	35	94	106	48	57.5
7N.07L	35	94	106	39.5	49
36.06L	36	89	106	48	57.5
36.07L	36	89	106	39.5	49

YOKE

STAR YOKE



Series	A(mm)	B(mm)	C(mm)	D(mm)
6.06ST	30.2	92	104	56.8
6.07ST	30.2	92	104	47.4
7.06ST	30.2	106.5	117	56.8
7.07ST	30.2	106.5	117	47.4
8.06ST	35	106.5	121	56.8
8.07ST	35	106.5	121	47.4
7N.06ST	35	94	106	56.8
7N.07ST	35	94	106	47.4
32.06ST	32	76	98	56.8
32.07ST	32	76	98	47.4
36.06ST	36	89	106	56.8
36.07ST	36	89	106	47.4
9.06ST	41	108	130	67.5
9.07ST	41	108	130	56.8
10.06ST	41	118	125	67.5
10.07ST	41	118	125	56.8
42.06ST	42	104.5	130	67.5
42.07ST	42	104.5	130	56.8
50.06ST	50	118	133	67.5
50.07ST	50	118	133	56.8

YOKE

GEAR YOKE



Series	A(mm)	B(mm)	C(mm)	D(mm)
2.06G	23.8	61.3	82	50
2.07G	23.8	61.3	82	35
4.06G	27	74.6	90	50
4.07G	27	74.6	90	35
5.06G	30.2	80	98	60
5.07G	30.2	80	98	40
6.06G	30.2	92	104	60
6.07G	30.2	92	104	40
7.06G	30.2	106.5	117	60
7.07G	30.2	106.5	117	40
8.06G	35	106.5	121	65
8.06G	35	106.5	121	45
38.06G	38	105.6	121	65
38.07G	38	105.6	121	45
42.06G	42	104.5	130	75
42.07G	42	104.5	130	55
50.06G	50	118	133	75
50.07G	50	118	133	55

YOKE

SPLINED YOKE 01-PUSH PIN

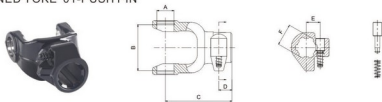

Series	A(mm)	B(mm)	C(mm)	D(mm)	E(mm)	F
1.0501B	22	54	93	21	22	1 3/8" Z6
2.0501B	23.8	61.3	99	21		
3.0501B	27	70	104	21		
4.0501B	27	74.6	106	21		
5.0501B	30.2	80	110	21		
32.0501B	32	76	110	21		
6.0501B	30.2	92	115	21		
7.0501B	30.2	106.5	130	21		
8.0501B	35	106.5	130	21		
38.0501B	38	105.6	130	21		

SPLINED YOKE 02-INTERFERING BOLT

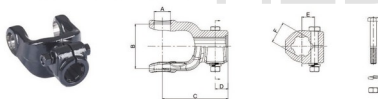

Series	A(mm)	B(mm)	C(mm)	D(mm)	E(mm)	F
1.0502B	22	54	93	23	21	1 3/8" Z6
1.0502D					22.8	1 3/8" Z21
1.0502G						8-32x38x6
2.0502B	23.8	61.3	102	21	21	1 3/8" Z6
2.0502D					22.8	1 3/8" Z21
2.0502G						8-32x38x6
3.0502B	27	70	108	21	21	1 3/8" Z6
3.0502D					22.8	1 3/8" Z21
3.0502G						8-32x38x6
4.0502B	27	74.6	108	21	21	1 3/8" Z6
4.0502D					22.8	1 3/8" Z21
4.0502G						8-32x38x6

YOKE

SPLINED YOKE 02-INTERFERING BOLT

Series	A(mm)	B(mm)	C(mm)	D(mm)	E(mm)	F
5.0502B	30.2	80	108	21	21	1 3/8" Z6
5.0502D						1 3/8" Z21
5.0502G						8-32x38x6
32.0502B	32	76	108	21	21	1 3/8" Z6
32.0502D						1 3/8" Z21
32.0502G						8-32x38x6
6.0502B	30.2	92	118	23	21	1 3/8" Z6
6.0502D						1 3/8" Z21
6.0502G						8-32x38x6
6.0502C			118		26	1 3/4" Z6
6.0502E				22		1 3/4" Z20
7.0502B	30.2	106.5	130	25	21	1 3/8" Z6
7.0502D						1 3/8" Z21
7.0502G						8-32x38x6
36.0502B	36	89	122	21	21	1 3/8" Z6
36.0502D						1 3/8" Z21
36.0502G						8-32x38x6
36.0502C			122	21	26	1 3/4" Z6
36.0502E						1 3/4" Z20
7N.0502B	35	94	122	21	21	1 3/8" Z6
7N.0502D						1 3/8" Z21
7N.0502G						8-32x38x6
7N.0502C			122	21	26	1 3/4" Z6
7N.0502E						1 3/4" Z20
8.0502B	35	106.5	130	25	21	1 3/8" Z6
8.0502D						1 3/8" Z21
8.0502G						8-32x38x6
8.0502C			130	25	26	1 3/4" Z6
8.0502E						1 3/4" Z20

SPLINED YOKE 03 -NON-INTERFREING BOLT

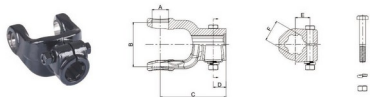

Series	A(mm)	B(mm)	C(mm)	D(mm)	E(mm)	F
1.0503B	22	54	93	23	23.5	1 3/8" Z6
1.0503D						1 3/8" Z21
2.0503B	23.8	61.3	102	21	23.5	1 3/8" Z6
2.0503D						1 3/8" Z21
3.0503B	27	70	108	21	23.5	1 3/8" Z6
3.0503D						1 3/8" Z21
4.0503B	27	74.6	108	21	23.5	1 3/8" Z6
4.0503D						1 3/8" Z21
5.0503B	30.2	80	108	21	25	1 3/8" Z6
5.0503D						1 3/8" Z21
32.0503B	32	76	108	21	25	1 3/8" Z6
32.0503D						1 3/8" Z21
6.0503B	30.2	92	118	23	25	1 3/8" Z6
6.0503D						1 3/8" Z21
7.0503B	30.2	106.5	130	25	25	1 3/8" Z6
7.0503D						1 3/8" Z21
7N.0503B	35	94	122	21	25	1 3/8" Z6
7N.0503D						1 3/8" Z21
8.0503B	35	106.5	130	25	25	1 3/8" Z6
8.0503D						1 3/8" Z21
8.0503C					1 3/4" Z6	
8.0503E					1 3/4" Z20	
36.0503B	36	89	122	21	25	1 3/8" Z6
36.0503D						1 3/8" Z21

SPLINED YOKE 04-WITH BALL ATTACHMENT

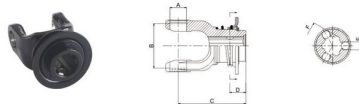

Series	A(mm)	B(mm)	C(mm)	D(mm)	E(mm)	F
1.0504B	22	54	100	26	Φ13	1 3/8" Z6
1.0504D						1 3/8" Z21
2.0504B	23.8	61.3	102	26	Φ13	1 3/8" Z6
2.0504D						1 3/8" Z21
3.0504B	27	70	111	26	Φ13	1 3/8" Z6
3.0504D						1 3/8" Z21
4.0504B	27	74.6	111	26	Φ13	1 3/8" Z6
4.0504D						1 3/8" Z21
5.0504B	30.2	80	117	26	Φ13	1 3/8" Z6
5.0504D						1 3/8" Z21
32.0504B	32	76	117	26	Φ13	1 3/8" Z6
32.0504D						1 3/8" Z21
6.0504B	30.2	92	123	26	Φ13	1 3/8" Z6
6.0504D						1 3/8" Z21
6.0504C			148	34	Φ16	1 3/4" Z6
6.0504E						1 3/4" Z20
7.0504B	30.2	106.5	137	26	Φ13	1 3/8" Z6
7.0504D						1 3/8" Z21
7N.0504B	35	94	123	26	Φ13	1 3/8" Z6
7N.0504D						1 3/8" Z21
8.0504B	35	106.5	130	26	Φ13	1 3/8" Z6
8.0504D						1 3/8" Z21
8.0504C			159	34	Φ16	1 3/4" Z6
8.0504E						1 3/4" Z20

YOKE

SPLINED YOKE 05-PUSH PIN

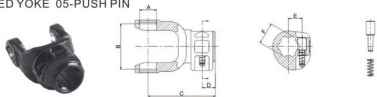

Series	A(mm)	B(mm)	C(mm)	D(mm)	E(mm)	F
1.0505B	22	54	93	21	22	1 3/8" Z6
1.0505D					22	1 3/8" Z21
1.0505G					23.8	8-32X38X6
2.0505B	23.8	61.3	99	21	22	1 3/8" Z6
2.0505D					22	1 3/8" Z21
2.0505G					23.8	8-32X38X6
3.0505B	27	70	102	21	22	1 3/8" Z6
3.0505D					22	1 3/8" Z21
3.0505G					23.8	8-32X38X6
4.0505B	27	74.6	108	21	22	1 3/8" Z6
4.0505D					22	1 3/8" Z21
4.0505G					23.8	8-32X38X6
5.0505B	30.2	80	111	21	22	1 3/8" Z6
5.0505D					22	1 3/8" Z21
5.0505G					23.8	8-32X38X6
32.0505B	32	76	111	21	22	1 3/8" Z6
32.03205D					22	1 3/8" Z21
32.03205G					23.8	8-32X38X6
6.0505B	30.2	92	117	21	22	1 3/8" Z6
6.0505D					22	1 3/8" Z21
6.0505G					23.8	8-32X38X6
7.0505B	30.2	106.5	130	21	22	1 3/8" Z6
7.0505D					22	1 3/8" Z21
7.0505G					23.8	8-32X38X6
36.0505B	36	89	119	21	22	1 3/8" Z6
36.0505D					22	1 3/8" Z21
36.0505G					23.8	8-32X38X6
7N.0505B	35	94	119	21	22	1 3/8" Z6
7N.0505D					22	1 3/8" Z21
7N.0505G					23.8	8-32X38X6
8.0505B	35	106.5	130	21	22	1 3/8" Z6
8.0505D					22	1 3/8" Z21
8.0505G					23.8	8-32X38X6

YOKE

SPLINED YOKE 07-PUSH PIN

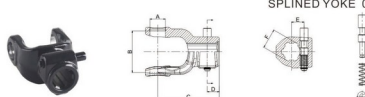

Series	A(mm)	B(mm)	C(mm)	D(mm)	E(mm)	F
1.0507B	22	54	93	23	22	1 3/8" Z6
1.0507D					22	1 3/8" Z21
1.0507G					23.8	8-32X38X6
2.0507B	23.8	61.3	102	21	22	1 3/8" Z6
2.0507D					22	1 3/8" Z21
2.0507G					23.8	8-32X38X6
3.0507B	27	70	108	21	22	1 3/8" Z6
3.0507D					22	1 3/8" Z21
3.0507G					23.8	8-32X38X6
4.0507B	27	74.6	108	21	22	1 3/8" Z6
4.0507D					22	1 3/8" Z21
4.0507G					23.8	8-32X38X6
5.0507B	30.2	80	108	21	22	1 3/8" Z6
5.0507D					22	1 3/8" Z21
5.0507G					23.8	8-32X38X6
32.0507B	32	76	108	21	22	1 3/8" Z6
32.0507D					22	1 3/8" Z21
32.0507G					23.8	8-32X38X6
6.0507B	30.2	92	118	23	22	1 3/8" Z6
6.0507D					22	1 3/8" Z21
6.0507G					23.8	8-32X38X6
6.0507C	30.2	106.5	118	22	26.5	1 3/4" Z6
6.0507E					26.5	1 3/4" Z20
7.0507B					22	1 3/8" Z6
7.0507D	22	1 3/8" Z21				
7.0507G	23.8	8-32X38X6				
8.0507B	35	106.5	130	25	22	1 3/8" Z6
8.0507D					22	1 3/8" Z21
8.0507G					23.8	8-32X38X6
8.0507C	35	106.5	130	25	26.5	1 3/4" Z6
8.0507E					26.5	1 3/4" Z20

SPLINED YOKE 08-PUSH PIN

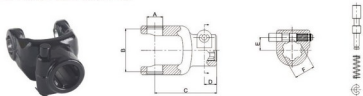

Series	A(mm)	B(mm)	C(mm)	D(mm)	E(mm)	F
1.0508B	22	54	89	14	22	1 3/8" Z6
1.0508D						1 3/8" Z21
2.0508B	23.8	61.3	100	20	22	1 3/8" Z6
2.0508D						1 3/8" Z21
3.0508B	27	70	102	22	22	1 3/8" Z6
3.0508D						1 3/8" Z21
4.0508B	27	74.6	108	21	22	1 3/8" Z6
4.0508D						1 3/8" Z21
5.0508B	30.2	80	111	20	22	1 3/8" Z6
5.0508D						1 3/8" Z21
32.0508B	32	76	111	20	22	1 3/8" Z6
32.0508D						1 3/8" Z21
6.0508B	30.2	92	118	21	22	1 3/8" Z6
6.0508D						1 3/8" Z21
6.0508C	30.2	92	124	24	26.5	1 3/4" Z6
6.0508E						1 3/4" Z20
7.0508B	30.2	106.5	125	24	22	1 3/8" Z6
7.0508D						1 3/8" Z21

SPLINED YOKE 11-PUSH PIN

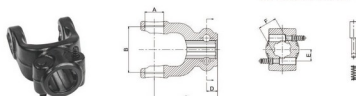

Series	A(mm)	B(mm)	C(mm)	D(mm)	E(mm)	F
6.0511B	30.2	92	121	21	22	1 3/8" Z6
6.0511D			121			1 3/8" Z21
6.0511G	30.2	92	121	21	23.8	8-32X38X6
6.0511C			121	21	26.5	1 3/4" Z6
36.0511B	36	89	121	21	22	1 3/8" Z6
36.0511D						121
36.0511G	36	89	121	21	23.8	8-32X38X6
36.0511C						121
36.0511E	36	89	121	21	26.5	1 3/4" Z20
7.0511B						128
7.0511D	30.2	106.5	128	21	22	1 3/8" Z21
7.0511G						128
8.0511B	35	106.5	128	21	22	1 3/8" Z6
8.0511D						128
8.0511G	35	106.5	128	21	23.8	8-32X38X6
8.0511C						128
8.0511E	35	106.5	128	21	26.5	1 3/4" Z20
10.0511B						140
10.0511D	41	118	140	28	23.8	8-32X38X6
10.0511G						140
10.0511C	41	118	140	28	26.5	1 3/4" Z20
10.0511E						140
42.0511B	42	104.5	138	21	23.8	8-32X38X6
42.0511D						138
42.0511G	42	104.5	138	21	26.5	1 3/4" Z20
42.0511C						138
42.0511E	42	104.5	138	21	23.8	8-32X38X6
50.0511B						145
50.0511D	50	118	145	21	22	1 3/8" Z6
50.0511G						145
50.0511C	50	118	145	21	26.5	1 3/4" Z6
50.0511E						145

YOKE

SPLINED YOKE 13-WITH COLLAR

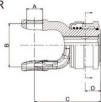

Series	A(mm)	B(mm)	C(mm)	D(mm)	E(mm)	F
1.0513B	22	54	100	26	Φ13	1 3/8"Z6
1.0513D						1 3/8"Z21
2.0513B	23.8	61.3	102	26	Φ13	1 3/8"Z6
2.0513D						1 3/8"Z21
3.0513B	27	70	111	26	Φ13	1 3/8"Z6
3.0513D						1 3/8"Z21
4.0513B	27	74.6	111	26	Φ13	1 3/8"Z6
4.0513D						1 3/8"Z21
5.0513B	30.2	80	117	26	Φ13	1 3/8"Z6
5.0513D						1 3/8"Z21
6.0513B	30.2	92	123	26	Φ13	1 3/8"Z6
6.0513D						1 3/8"Z21
6.0513C	30.2	92	123	26	Φ13	1 3/8"Z6
6.0513E						1 3/8"Z21
7.0513B	30.2	106.5	137	26	Φ13	1 3/8"Z6
7.0513D						1 3/8"Z21
36.0513B	36	89	123	26	Φ13	1 3/8"Z6
36.0513D						1 3/8"Z21
7N.0513B	35	94	123	26	Φ13	1 3/8"Z6
7N.0513D						1 3/8"Z21
8.0513B	35	106.5	137	26	Φ13	1 3/8"Z6
8.0513D						1 3/8"Z21
8.0513C	35	106.5	137	26	Φ16	1 3/4"Z6
8.0513E						1 3/4"Z20

YOKE

PLAIN BORE YOKE A-PIN HOLE

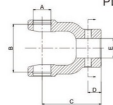

Series	A(mm)	B(mm)	C(mm)	D(mm)	E(mm)	F(mm)
1.05A20	22	54	77	20	20	6
1.05A22					22	8
1.05A25					25	10
1.05A30					30	10
1.05A31.8	23.8	61.3	82	20	31.8	10
2.05A20					20	6
2.05A22					22	8
2.05A25					25	8
2.05A30	27	70	90	20	30	10
3.05A22					22	8
3.05A25					25	8
3.05A30					30	10
3.05A35	30.2	80	98	20	35	13
4.05A22					22	8
4.05A25					25	8
4.05A30					30	10
4.05A31.8	30.2	80	98	20	31.8	10
4.05A35					25	13
5.05A30					30	10
5.05A35					35	13
5.05A40	30.2	80	98	20	40	13
6.05A30					30	10
6.05A35					35	13
6.05A40					40	13
6.05A42	30.2	106.5	117	25	42	13
7.05A35					35	13
7.05A40					40	13
7.05A42					42	13
7.05A45	35	106.5	121	25	45	13
8.05A35					35	13
8.05A40					40	13
8.05A42					42	13
8.05A45	45	13				

PLAIN BORE YOKE B-KEYWAY

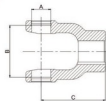

Series	A(mm)	B(mm)	C(mm)	D(mm)	E(mm)	F(mm)
1.05B20	22	54	77	20	6	12.8
1.05B22				22		13.8
1.05B25				25		15.8
1.05B30				30		18.3
2.05B20	23.8	61.3	82	20	6	12.8
2.05B22				22		13.8
2.05B25				25		15.8
3.05B22	27	70	90	22	8	13.8
3.05B25				25		15.8
3.05B30				30		18.3
3.05B35				35		20.8
4.05B22	27	74.6	90	22	6	13.8
4.05B25				25		15.8
4.05B30				30		18.3
4.05B35				35		20.8
5.05B30				30		18.3
5.05B35	30.2	80	98	35	10	20.8
5.05B40				40		23.3
6.05B30				30		18.3
6.05B35	30.2	92	104	35	10	20.8
6.05B40				40		23.3
6.05B42				42		24.3
7.05B35				35		20.8
7.05B40	30.2	106.5	117	40	12	23.3
7.05B42				42		24.3
7.05B45				45		26.3
8.05B35				35		20.8
8.05B40	35	106.5	121	40	12	23.3
8.05B42				42		24.3
8.05B45				45		26.3

PLAIN BORE YOKE C-KEYWAY & THREADED HOLE

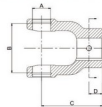

Series	A(mm)	B(mm)	C(mm)	D(mm)	E(mm)	F(mm)	G(mm)	H(mm)		
1.05C20	22	54	77	20	6	12.8	20	M6		
1.05C22						13.8	22	M8		
1.05C25						15.8	25	M8		
1.05C30						18.3	30	M8		
2.05C20	23.8	61.3	82	20	6	12.8	20	M6		
2.05C22						13.8	22	M6		
2.05C25						15.8	25	M8		
2.05C30	23.8	61.3	82	20	8	18.3	30	M8		
3.05C22						15	6	13.8	22	M6
3.05C25						15.8	25	M8		
3.05C30						18.3	30	M8		
3.05C35	27	70	90	20	8	20.8	35	M10		
4.05C22						6	13.8	22	M6	
4.05C25						8	15.8	25	M8	
4.05C30	27	74.6	90	20	8	18.3	30	M8		
4.05C35						10	20.8	35	M10	
5.05C30						8	18.3	30	M8	
5.05C35						10	20.8	35	M10	
5.05C40	30.2	80	98	20	10	20.8	35	M10		
6.05C30						8	18.3	30	M8	
6.05C35						10	20.8	35	M10	
6.05C40	30.2	92	104	20	10	23.3	40	M12		
6.05C42						12	24.3	42	M12	
7.05C35						10	20.8	35	10	
7.05C40						12	23.3	40	12	
7.05C42	30.2	106.5	117	25	12	24.3	42	12		
7.05C45						14	26.3	45	14	
8.05C35						10	20.8	35	M10	
8.05C40	35	106.5	121	25	12	23.3	40	M12		
8.05C42						24.3	42	M12		
8.05C45						14	26.3	45	M14	

PLAIN BORE YOKE D-KEYWAY & CLAMP BOLT

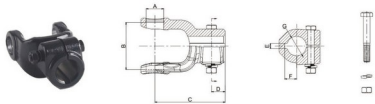

Series	A(mm)	B(mm)	C(mm)	D(mm)	E(mm)	F(mm)	G(mm)
1.05D20	22	54	93	21	6	12.8	20
1.05D30					8	18.3	30
1.05D32					10	19.3	32
2.05D25	23.8	61.3	102	21	8	15.8	25
2.05D30					10	18.3	30
2.05D32					10	19.3	32
3.05D25	27	70	108	21	8	15.8	25
3.05D32					8	19.3	32
3.05D35					12	20.8	35
4.05D25	27	74.6	108	21	8	15.8	25
4.05D32					8	19.3	32
4.05D38					10	22.3	38
5.05D32	30.2	80	108	21	10	19.3	32
5.05D35					10	20.8	35
6.05D30					8	18.3	30
6.05D32	30.2	92	118	21	10	19.3	32
6.05D38					12	22.3	38
6.05D45					14	26.3	45
6.05D50	30.2	106.5	130	25	8	18.3	30
7.05D30					10	20.8	35
7.05D35					12	23.3	40
8.05D30	35	106.5	130	25	8	18.3	30
8.05D35					10	20.8	35
8.05D40					12	23.3	40
8.05D45					14	26.3	45

PLAIN BORE YOKE F-VERTICAL PIN HOLE

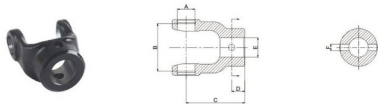

Series	A(mm)	B(mm)	C(mm)	D(mm)	E(mm)	F(mm)
1.05F20	22	54	77	15	20	6
1.05F22					22	8
1.05F25					25	8
1.05F30	23.8	61.3	82	15	30	10
1.05F31.8					18.5	31.8
2.05F20					20	6
2.05F22	27	70	90	20	22	8
2.05F25					25	8
2.05F30					30	10
3.05F22	30.2	80	98	20	15	8
3.05F25					25	8
3.05F30					30	10
3.05F35	30.2	92	104	20	35	13
4.05F22					22	8
4.05F25					25	8
4.05F30	30.2	92	104	20	30	10
4.05F31.8					31.8	10
4.05F35					35	13
5.05F30	30.2	106.5	117	25	30	10
5.05F35					35	13
5.05F40					40	10
6.05F30	35	106.5	121	25	30	10
6.05F35					35	13
6.05F40					40	13
6.05F42					42	13
7.05F35	30.2	106.5	117	25	42	13
7.05F40					40	13
7.05F42					42	13
7.05F45	35	106.5	121	25	45	13
8.05F35					35	13
8.05F40					40	13
8.05F42	35	106.5	121	25	42	13
8.05F45					45	13

YOKE

PLAIN BORE YOKE H-PIN HOLE & THREADED HOLE

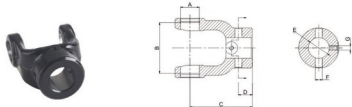

Series	A(mm)	B(mm)	C(mm)	D(mm)	E(mm)	F(mm)	G(mm)
1.05H20	22	54	77	15	20	6	M6
1.05H22					22	8	
1.05H25					25	8	
1.05H30					30	10	
1.05H31.8				18.5	31.8	10	
2.05H20	23.8	61.3	82	15	20	6	M6
2.05H22					22	8	
2.05H25					25	8	
2.05H30					30	10	
3.05H22	27	70	90	20	15	22	M6
3.05H25					25	8	
3.05H30					30	10	
3.05H35					35	13	
4.05H22	27	74.6	90	20	22	8	M6
4.05H25					25	8	
4.05H30					30	10	
4.05H31.8					31.8	10	
4.05H35				15	35	13	M8
5.05H30	30.2	80	98	20	30	10	M6
5.05H35					35	13	M8
5.05H40					40	13	M10
6.05H30					30	10	M6
6.05H35	30.2	92	104	20	35	13	M8
6.05H40					40	13	M10
6.05H42					42	13	M10
7.05H35					35	13	M8
7.05H40	30.2	106.5	117	25	40	13	M10
7.05H42					42	13	
7.05H45					45	13	
8.05H35					35	13	
8.05H40	35	106.5	121	25	40	13	M10
8.05H42					42	13	
8.05H45					45	13	

TORQUE LIMITER

**Shear Bolt
Torque Limiter**



SB

Overrunning Clutch



RA



RAS

**Ratchet Torque
Limiter**



SA

Wide Angle Joint



WA



SD



SC

**Friction Torque
Limiter**



FF



FFS



FT

**Friction Torque
Limiter**



FCS

SHEAR BOLT TORQUE LIMITER

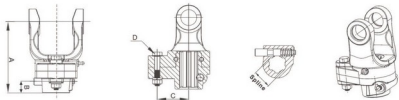

Series	Torque(nm)	Spline	A(mm)	B(mm)	C(mm)	D(mm)
1SB	570	1 3/8"Z6	95	20	35	M6×40
1SBT1	740				45	
2SB	740				45	
2SBT1	790		98	21	48	M6×40
3SB	1110				38	
3SBT1	1200		102	21	40	M8×45
4SB	1400				48	
4SBT1	1600				55	
5SB	1600		107	21	55	M8×50
5SBT1	2100				46	
6SB	1750	60				
6SBT1	2500	137	24	55	M10×55	
32SB	1600			55		
32SBT1	2100	114	24	46	M10×50	
7SB	2050			45		
7SBT1	3200			49		

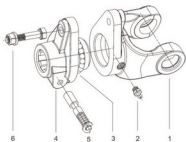

No.	Description	Notes
1	Yoke	
2	Grease nipple	
3	Steel ball	
4	Hub	
5	Push pin	
6	Shear bolt & Nut	

SHEAR BOLT TORQUE LIMITER

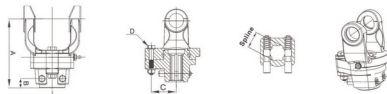

Series	Torque(nm)	Spline	A(mm)	B(mm)	C(mm)	D(mm)
7NSB	2300	1 3/8"Z6	139	24	50	M10×65
7NSBT1	3000				46	
8SB	2700	1 3/8"Z6	152	24	60	M10×65
8SBT1	3500				57	
8SB.C	2700				60	
8SBT1.C	3500				57	
38SB	2700				60	
9SB	3500				57	
9SBT1	4000				60	
9SB.C	3500				57	
9SBT1.C	4000				60	
10SB	3500				1 3/4"Z6	
10SBT1	4500	49				
10SB.C	3500	57				
10SBT1.C	4500	49				
36SB	2400	53				
36SBT1	3200	49				
42SB	3500	57				
42SBT1	4000	60				
42SB.C	3500	57				
42SBT1.C	4000	60				

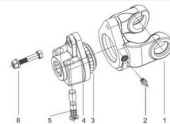

No.	Description	Notes
1	Yoke	
2	Grease nipple	
3	Steel ball	
4	Hub	
5	Push pin	Qty.=2
6	Shear bolt & Nut	

OVERRUNNING CLUTCH

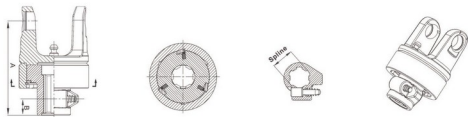

Series	Max Torque(nm)	Spline	A(mm)	B(mm)
1RA1	2400	1 3/8"Z6	138	21
2RA1			138	
3RA1			149	
4RA1			150	
5RA1			154	
6RA1			160	
7RA1			171	
7NRA1			157	
8RA1	171			

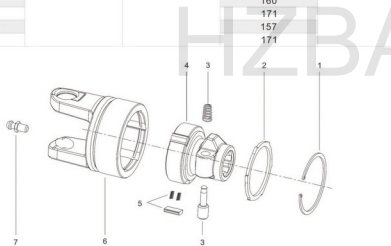

No.	Description	Notes
1	Circlip	
2	Retaining washer	
3	Push pin kit	
4	Hub	
5	Prong kit	Qty.=3
6	Housing with yoke	
7	Grease nipple	

OVERRUNNING CLUTCH

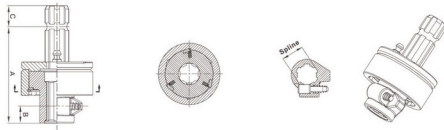

Series	Max Torque(nm)	Spline(female)	Spline(male)	A(mm)	B(mm)	C(mm)
RAS1	2400	1 3/8"Z6	1 3/8"Z6	142	21	38

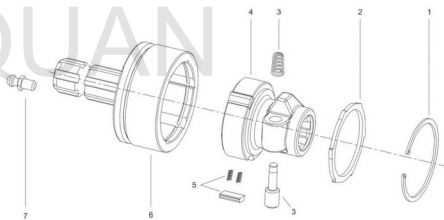

No.	Description	Notes
1	Circlip	
2	Retaining washer	
3	Push pin kit	
4	Hub	
5	Prong kit	Qty.=3
6	Housing with splined shaft	
7	Grease nipple	

OVERRUNNING CLUTCH

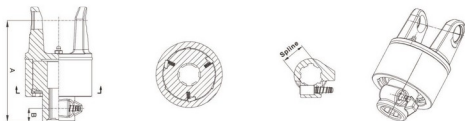

Series	Max Torque(nm)	Spline	A(mm)	B(mm)
5RA2	3500	1 3/8"Z6	172	21
6RA2			178	
7NRA2			175	
6RA2			178	
8RA2			189	

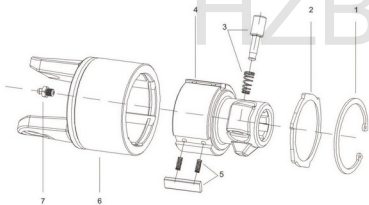

No.	Description	Notes
1	Circlip	
2	Retaining washer	
3	Push pin kit	
4	Hub	
5	Prong kit	Qty.=3
6	Housing with yoke	
7	Grease nipple	

OVERRUNNING CLUTCH

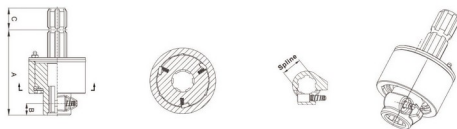

Series	Max Torque(nm)	Spline(female)	Spline(male)	A(mm)	B(mm)	C(mm)
RAS2	3500	1 3/8"Z6	1 3/8"Z6	161	21	38

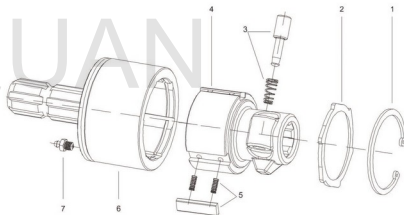

No.	Description	Notes
1	Circlip	
2	Retaining washer	
3	Push pin kit	
4	Hub	
5	Prong kit	Qty.=3
6	Housing with splined shaft	
7	Grease nipple	

RATCHET TORQUE LIMITER

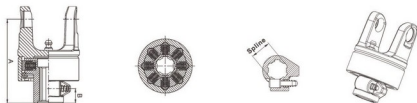

Series	Setting Torque (nm)	Spline	A(mm)	B(mm)
1SA1	400	1 3/8"Z6	138	21
2SA1			138	
3SA1			149	
4SA1			150	

RATCHET TORQUE LIMITER

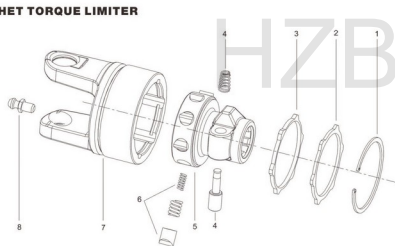

No.	Description	Notes
1	Circlip	
2	Retaining washer	
3	Dust guard ring	
4	Push pin kit	
5	Hub	
6	Pawl kit	Qty.=8
7	Housing with yoke	
8	Grease nipple	

RATCHET TORQUE LIMITER

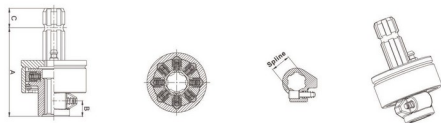

Series	Setting Torque(nm)	Spline(female)	Spline(male)	A(mm)	B(mm)	C(mm)
SAS1	400	1 3/8"Z6	1 3/8"Z6	144	21	38

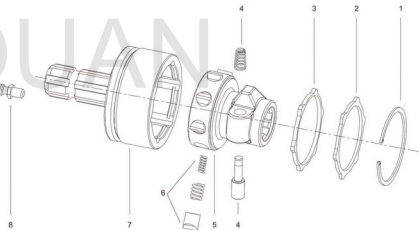

No.	Description	Notes
1	Circlip	
2	Retaining washer	
3	Dust guard ring	
4	Push pin kit	
5	Hub	
6	Pawl kit	Qty.=8
7	Housing with yoke	
8	Grease nipple	

RATCHET TORQUE LIMITER

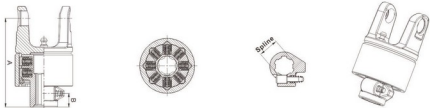

Series	Setting Torque (nm)	Spline	A(mm)	B(mm)
1SA2	800	1 3/8"Z6	156	21
2SA2			156	
3SA2			167	
4SA2			168	
5SA2			172	
6SA2			178	
7SA2			189	
7NSA2			175	
8SA2	189			

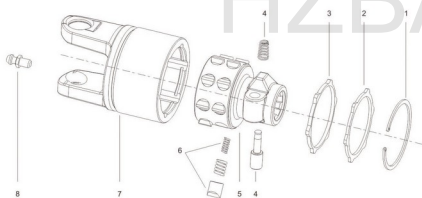

No.	Description	Notes
1	Circlip	
2	Retaining washer	
3	Dust guard ring	
4	Push pin kit	
5	Hub	
6	Pawl kit	Qty.=16
7	Housing with yoke	
8	Grease nipple	

RATCHET TORQUE LIMITER

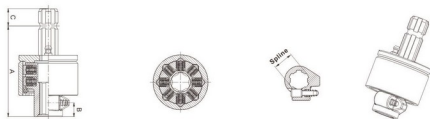

Series	Setting Torque(nm)	Spline(female)	Spline(male)	A(mm)	B(mm)	C(mm)
SAS2	800	1 3/8"Z6	1 3/8"Z6	161	21	38

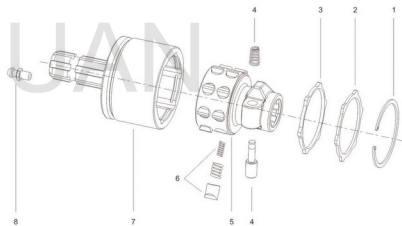

No.	Description	Notes
1	Circlip	
2	Retaining washer	
3	Dust guard ring	
4	Push pin kit	
5	Hub	
6	Pawl kit	Qty.=16
7	Housing with yoke	
8	Grease nipple	

RATCHET TORQUE LIMITER

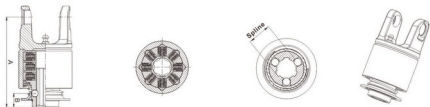

Series	Setting Torque (nm)	Spline	A(mm)	B(mm)
2SA3	1200	1 3/8"Z6	171	22
3SA3			182	
4SA3			183	
5SA3			187	
6SA3			193	
7SA3			204	
7NSA3			190	
8SA3			204	

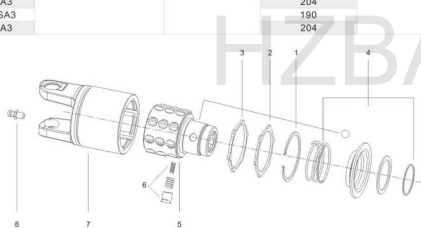

No.	Description	Notes
1	Circlip	
2	Retaining washer	
3	Dust guard ring	
4	Push pin kit	
5	Hub	
6	Pawl kit	Qty.=24
7	Housing with yoke	
8	Grease nipple	

RATCHET TORQUE LIMITER

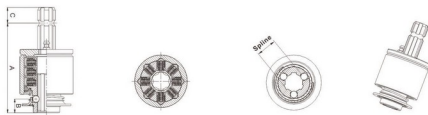

Series	Setting Torque(nm)	Spline(female)	Spline(male)	A(mm)	B(mm)	C(mm)
SAS3	1200	1 3/8"Z6	1 3/8"Z6	164.5	22	38

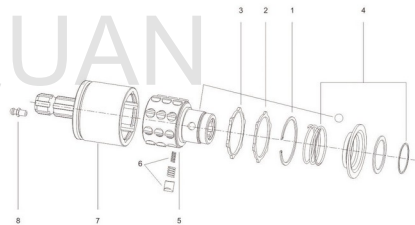

No.	Description	Notes
1	Circlip	
2	Retaining washer	
3	Dust guard ring	
4	Ball collar kit	
5	Hub	
6	Pawl kit	Qty.=24
7	Housing with yoke	
8	Grease nipple	

RATCHET TORQUE LIMITER

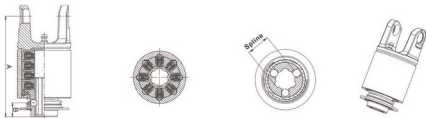

Series	Setting Torque (nm)	Spline	A(mm)	B(mm)
5SA4	1600	1 3/8"Z6	206	22
6SA4	1600	1 3/8"Z6	212	22

RATCHET TORQUE LIMITER

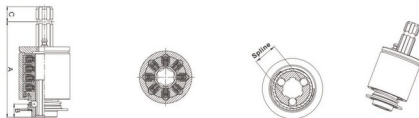

Series	Setting Torque(nm)	Spline(female)	Spline(male)	A(mm)	B(mm)	C(mm)
SAS4	1600	1 3/8"Z6	1 3/8"Z6	186	22	38

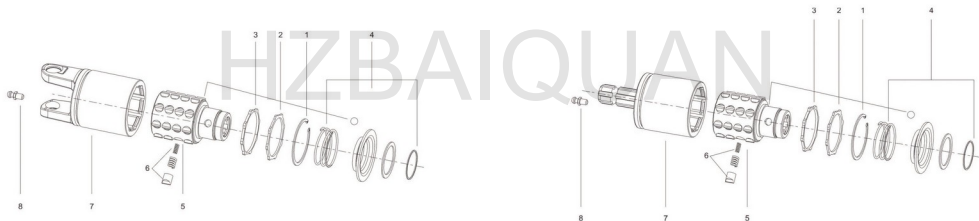

No.	Description	Notes
1	Circlip	
2	Retaining washer	
3	Dust guard ring	
4	Ball collar kit	
5	Hub	
6	Pawl kit	Qty.=32
7	Housing with yoke	
8	Grease nipple	

No.	Description	Notes
1	Circlip	
2	Retaining washer	
3	Dust guard ring	
4	Ball collar kit	
5	Hub	
6	Pawl kit	Qty.=32
7	Housing with yoke	
8	Grease nipple	

RATCHET TORQUE LIMITER

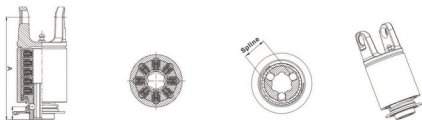

Series	Setting Torque (nm)	Spline	A(mm)	B(mm)
6SA6	2000	1 3/8"Z6	231	22

RATCHET TORQUE LIMITER

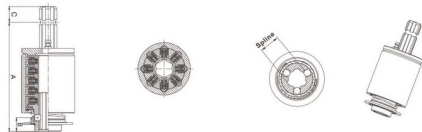

Series	Setting Torque(nm)	Spline(female)	Spline(male)	A(mm)	B(mm)	C(mm)
SAS5	2000	1 3/8"Z6	1 3/8"Z6	205	22	38

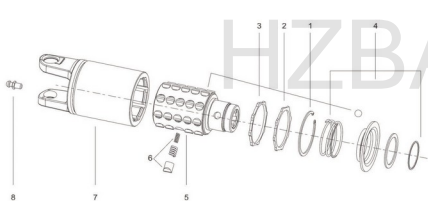

No.	Description	Notes
1	Circlip	
2	Retaining washer	
3	Dust guard ring	
4	Ball collar kit	
5	Hub	
6	Pawl kit	Qty.=40
7	Housing with yoke	
8	Grease nipple	

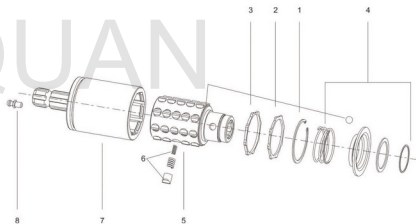

No.	Description	Notes
1	Circlip	
2	Retaining washer	
3	Dust guard ring	
4	Ball collar kit	
5	Hub	
6	Pawl kit	Qty.=40
7	Housing with yoke	
8	Grease nipple	

WIDE ANGLE JOINT

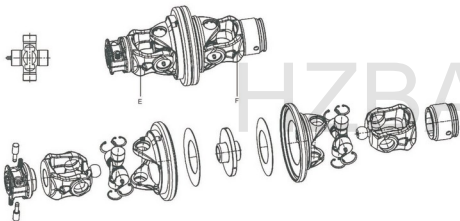
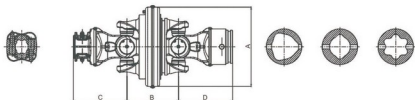

Series	Cross	A(mm)	B(mm)	C(mm)	D(mm)	E	F
2WA.01	23.8*61.3/22*76	153	104	119	105	2WA.0505B/D/G	2WA.06/06L
4WA.01	27*74.6/23.8*91	153	104	124	110	4WA.0505B/D/G	4WA.06/06L
6WA.01	30.2*92/27*100	176	105	136	127	6WA.0505B/D/G	6WA.06/06L/06ST
8WA.01	35*106.5/30.2*106	184	120	146	147	8WA.0505B/C/D/E	8WA.06/06L/06ST
32WA.01	32*76/27*94	176	105	126	117	32WA.0505B/D/G	32WA.06/06L/06ST
36WA.01	36*89/32*106	184	120	125	126	36WA.0505B/C/D/E	36WA.06/06L/06ST
42WA.01	42*104.5/36*124	184	124	149	150	42WA.0505B/C/D/E	42WA.06/06ST/06G

SD-DOUBLE JOINT

SD-DOUBLE JOINT (WHOLE)

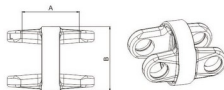

Series	Type	A(mm)	B(mm)
1	1.05.DY	66	72
2	2.05.DY	69	78
3	3.05.DY	79	80
4	1310.05.DY	68.5	99
5	100.05.DY	70	109
6	25HP.05.DY	69	78
7	50HP.05.DY	70	109

SD-DOUBLE JOINT (WELDED)

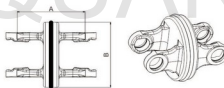

Series	Type	A(mm)	B(mm)
1	1.05.SDY	102	102
2	2.05.SDY	102	102
3	3.05.SDY	124	102
4	4.05.SDY	126	102
5	5.05.SDY	134	102
6	6.05.SDY	146	102
7	7.05.SDY	168	102
7N	7N.05.SDY	140	102
8	8.05.SDY	168	102
32	32.05.SDY	134	102
36	36.05.SDY	154	102
42	42.05.SDY	190	104

SD-DOUBLE JOINT (WHOLE)



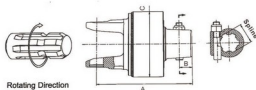

Series	Torque(nm)	Spline	A(mm)	B(mm)	C(mm)
4SC151	1600	1 3/8"Z6	207.5	28	Φ152
4SC151.D		1 3/8"Z21			
5SC151		1 3/8"Z6			
6SC151.D	2100	1 3/8"Z21	213		
6SC151		1 3/8"Z6			
6SC151.D		1 3/8"Z21			
6SC151.C	2100	1 3/4"Z6	213		
6SC151.E		1 3/4"Z20			
7NSC151		1 3/8"Z6			
7NSC151.D	2800	1 3/8"Z21	213		
7NSC151.C		1 3/4"Z6			
7NSC151.E		1 3/4"Z20			
8SC151	2600	1 3/8"Z6	220		
8SC151.D		1 3/8"Z21			
8SC151.C		1 3/4"Z6			
8SC151.E	2600	1 3/4"Z20	220		
36SC151		1 3/8"Z6			
36SC151.D		1 3/8"Z21			
36SC151.C	2800	1 3/4"Z6	213		
36SC151.E		1 3/4"Z20			
8SC176		1 3/8"Z6			
8SC176.D	3000	1 3/8"Z21	224		
8SC176.C		1 3/8"Z6			
8SC176.E		1 3/8"Z21			
9SC176	3500	1 3/8"Z6	233		
9SC176.D		1 3/8"Z21			
9SC176.C		1 3/4"Z6			
9SC176.E	4000	1 3/4"Z20	233		
8SC176		1 3/8"Z6			
8SC176.D		1 3/8"Z21			
8SC176.C	4500	1 3/4"Z6	233		
8SC176.E		1 3/4"Z20			
8SC176		1 3/8"Z6			
8SC176.D	4000	1 3/8"Z21	233		
8SC176.C		1 3/4"Z6			
8SC176.E		1 3/4"Z20			
8SC176	3500	1 3/8"Z6	233		
8SC176.D		1 3/8"Z21			
8SC176.C		1 3/4"Z6			
8SC176.E	4500	1 3/4"Z20	233		
8SC176		1 3/8"Z6			
8SC176.D		1 3/8"Z21			
8SC176.C	4500	1 3/4"Z6	233		
8SC176.E		1 3/4"Z20			
8SC176		1 3/8"Z6			

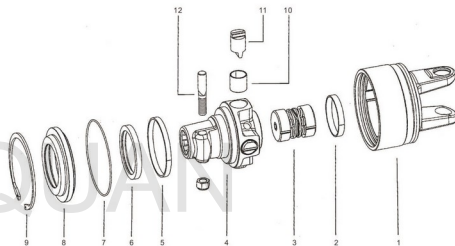

No.	Description	Notes
1	Outer housing + yoke	
2	Bushing	
3	Spring pack	
4	Hub with taper pin and bushings	
5	Bushing	
6	Sealing ring	
7	O-ring	
8	Locking plate	
9	Snap ring	
10	Bushing	Qty.=4
11	Cam	Qty.=4
12	Taper pin	With nuts



Rotating Direction



Series	Torque(nm)	Spline	A(mm)	B(mm)	C(mm)
SCF151	1600	1 3/8"Z6	171	29	Φ168
SCF151.D	2100	1 3/8"Z21			
SCF151.C	2600	1 3/4"Z6			
SCF151.E	2800	1 3/4"Z20			
SCF176	3000	1 3/8"Z6			
SCF176.D	3500	1 3/8"Z21	175	28	Φ176
SCF176.C	4000	1 3/4"Z6			
SCF176.E	4500	1 3/4"Z20			

HZBAIQW

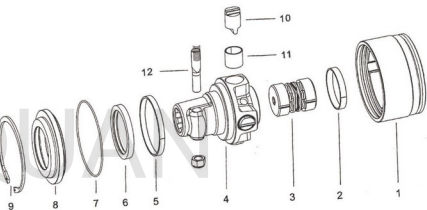

No.	Description	Notes
1	Outer housing+flange	
2	Bushing	
3	Spring pack	
4	Hub with taper pin and bushings	
5	Bushing	
6	Sealing ring	
7	O-ring	
8	Locking plate	
9	Snap ring	
10	Bushing	Qty.=4
11	Cam	Qty.=4
12	Taper pin	With nuts

FRICTION TORQUE LIMITER

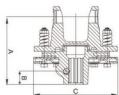

Series	Max Torque(nm)	Friction Disc	Spline	A(mm)	B(mm)	C(mm)
4FF0	800	Φ120	1 3/8"Z6	135	29	Φ160
5FF0	1000		1 3/8"Z21	137		
4FF1	1200	Φ140	1 3/8"Z6	150	29	Φ180
4FF1D			1 3/8"Z21			
5FF1			1 3/8"Z6			
5FF1D			1 3/8"Z21			
6FF1	1500	Φ160	1 3/8"Z6	150	29	Φ200
6FF1D			1 3/8"Z21			
4FF2	1500	Φ160	1 3/8"Z6	150	29	Φ200
4FF2D			1 3/8"Z21			
5FF2	1500	Φ160	1 3/8"Z6	152	29	Φ200
5FF2D			1 3/4"Z20			
5FF2C			1 3/4"Z6			
5FF2E			1 3/4"Z20			
6FF2	1500	Φ160	1 3/8"Z6	164	29	Φ200
6FF2D			1 3/8"Z21			
6FF2C			1 3/4"Z6			
6FF2E			1 3/4"Z20			
7FF2	1800	Φ160	1 3/8"Z6	169	29	Φ200
7FF2D			1 3/8"Z21			
7FF2C			1 3/4"Z6			
7FF2E			1 3/4"Z20			
7NFF2			1 3/8"Z6			
7NFF2D			1 3/8"Z21			
7NFF2C	1 3/4"Z6					
7NFF2E	1 3/4"Z20					
8FF2	1800	Φ160	1 3/8"Z6	169	29	Φ200
8FF2D			1 3/8"Z21			
8FF2C			1 3/4"Z6			
8FF2E			1 3/4"Z20			

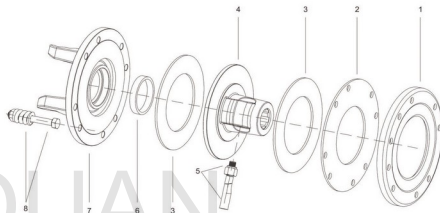

No.	Description	Notes
1	Pressure plate	
2	Internal disc	
3	Friction lining	Qty.=2
4	Hub	
5	Taper pin for hub	With nuts
6	Bushing	
7	Flanged yoke	
8	Complete bolt&Spring	Qty.=8

FRICTION TORQUE LIMITER

FRICTION TORQUE LIMITER

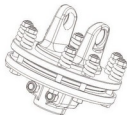
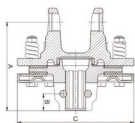

Series	Max Torque(nm)	Friction Disc	Spline	A(mm)	B(mm)	C(mm)
4FFV1	1200	Φ140	1 3/8"Z6	150	30.5	Φ180
4FFV1D	900		1 3/8"Z21			
5FFV1	1200		1 3/8"Z6			
5FFV1D	900	Φ140	1 3/8"Z21	152	30.5	Φ180
6FFV1	1200		1 3/8"Z6			
6FFV1D	1200		1 3/8"Z21			
4FFV2	1200	Φ160	1 3/8"Z6	143	26	Φ200
4FFV2D	1200		1 3/8"Z21			
5FFV2	1500		1 3/8"Z6			
5FFV2D		1 3/8"Z21	145	26	Φ200	
5FFV2C		1 3/4"Z6				
5FFV2E	1 3/4"Z20					
6FFV2	1500	Φ160	1 3/8"Z6	157	26	Φ200
6FFV2D			1 3/8"Z21			
6FFV2C			1 3/4"Z6			
6FFV2E	1800	Φ160	1 3/4"Z20	163	30.5	Φ200
7FFV2			1 3/8"Z6			
7FFV2D			1 3/8"Z21			
7FFV2C	1800	Φ160	1 3/4"Z6	168	30.5	Φ200
7FFV2E			1 3/4"Z20			
7NFFV2			1 3/8"Z6			
7NFFV2D	1800	Φ160	1 3/8"Z21	157	26	Φ200
7NFFV2C			1 3/4"Z6			
7NFFV2E			1 3/4"Z20			
8FFV2	1800	Φ160	1 3/8"Z6	162	26	Φ200
8FFV2D			1 3/8"Z21			
8FFV2C			1 3/4"Z6			
8FFV2E			1 3/4"Z20			

FRICTION TORQUE LIMITER

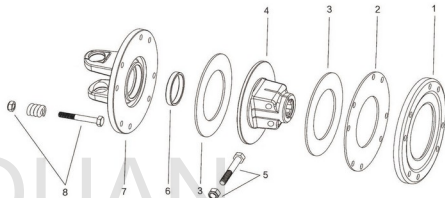

No.	Description	Notes
1	Pressure plate	
2	Internal disc	
3	Friction lining	Qty.=2
4	Hub	
5	Complete bolt	Qty.=2
6	Bushing	
7	Flanged yoke	
8	Complete bolt&Spring	Qty.=8

FRICTION TORQUE LIMITER

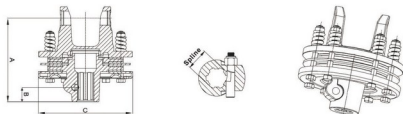

Series	Max Torque(nm)	Friction Disc	Spline	A(mm)	B(mm)	C(mm)
5FF3	2000	Φ140	1 3/8"Z6	168	29	Φ180
5FF3.D			1 3/8"Z21			
6FF3			1 3/8"Z6			
6FF3.D	2000	Φ140	1 3/8"Z6	176	29	Φ180
5FF4			1 3/8"Z6			
5FF4.D			1 3/8"Z21			
5FF4C	2000	Φ160	1 3/4"Z6	168	29	Φ200
5FF4E			1 3/4"Z20			
6FF4			1 3/8"Z6			
6FF4.D	2000	Φ160	1 3/8"Z21	180	29	Φ200
6FF4C			1 3/4"Z6			
6FF4E			1 3/4"Z20			
7FF4			1 3/8"Z6	185	29	Φ200
7FF4.D			1 3/8"Z21			
7FF4C			1 3/4"Z6			
7FF4E	2200	Φ160	1 3/4"Z20	180	29	Φ200
7NFF4			1 3/8"Z6			
7NFF4.D			1 3/8"Z21			
7NFF4C			1 3/4"Z6	185	29	Φ200
7NFF4E			1 3/4"Z20			
8FF4			1 3/8"Z6			
8FF4.D	2500	Φ160	1 3/8"Z21	185	29	Φ200
8FF4C			1 3/4"Z6			
8FF4E			1 3/4"Z20			
9FF4	2800	Φ160	1 3/8"Z6	190	29	Φ200
9FF4.D			1 3/8"Z21			
9FF4C			1 3/4"Z6			
9FF4E			1 3/4"Z20	190	29	Φ200
10FF4			1 3/8"Z6			
10FF4.D			1 3/8"Z21			
10FF4C	3000	Φ160	1 3/4"Z6	190	29	Φ200
10FF4E			1 3/4"Z20			
42FF4			1 3/8"Z6			
42FF4.D	2800	Φ160	1 3/8"Z21	190	29	Φ200
42FF4C			1 3/4"Z6			
42FF4E			1 3/4"Z20			

FRICTION TORQUE LIMITER

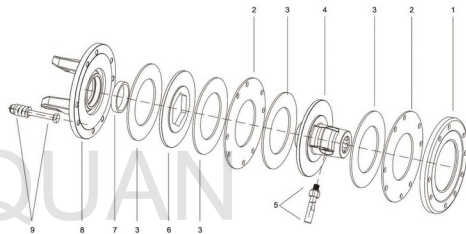

No.	Description	Notes
1	Pressure plate	
2	Internal disc	Qty.=2
3	Friction lining	Qty.=4
4	Hub	
5	Taper pin for hub	With nuts
6	Intermediate hub	
7	Bushing	
8	Flanged yoke	
9	Complete bolt&Spring	Qty.=8

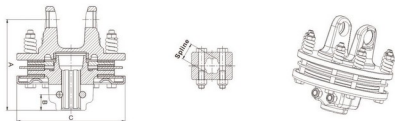

Series	Max Torque(nm)	Friction Disc	Spline	A(mm)	B(mm)	C(mm)
5FFV3	2000	Φ140	1 3/8"Z6	160	30.5	Φ180
5FFV3.D			1 3/8"Z21			
6FFV3	2000	Φ140	1 3/8"Z6	168	30.5	Φ180
6FFV3.D			1 3/8"Z21			
5FFV4	2000	Φ160	1 3/8"Z6	160	30.5	Φ200
5FFV4D			1 3/8"Z21			
5FFV4C	2000	Φ160	1 3/4"Z6	167	30.5	Φ200
5FFV4E			1 3/4"Z20			
6FFV4	2000	Φ160	1 3/8"Z6	172	30.5	Φ200
6FFV4D			1 3/8"Z21			
6FFV4C	2000	Φ160	1 3/4"Z6	179	30.5	Φ200
6FFV4E			1 3/4"Z20			
7FFV4	2200	Φ160	1 3/8"Z6	177	30.5	Φ200
7FFV4D			1 3/8"Z21			
7FFV4C	2200	Φ160	1 3/4"Z6	184	30.5	Φ200
7FFV4E			1 3/4"Z20			
7NFFV4	2200	Φ160	1 3/8"Z6	172	30.5	Φ200
7NFFV4D			1 3/8"Z21			
7NFFV4C	2200	Φ160	1 3/4"Z6	179	30.5	Φ200
7NFFV4E			1 3/4"Z20			
8FFV4	2500	Φ160	1 3/8"Z6	177	30.5	Φ200
8FFV4D			1 3/8"Z21			
8FFV4C	2500	Φ160	1 3/4"Z6	184	30.5	Φ200
8FFV4E			1 3/4"Z20			
9FFV4	2800	Φ160	1 3/8"Z6	182	30.5	Φ200
9FFV4D			1 3/8"Z21			
9FFV4C	2800	Φ160	1 3/4"Z6	189	30.5	Φ200
9FFV4E			1 3/4"Z20			
10FFV4	2800	Φ160	1 3/8"Z6	182	30.5	Φ200
10FFV4D			1 3/8"Z21			
10FFV4C	2800	Φ160	1 3/4"Z6	189	30.5	Φ200
10FFV4E			1 3/4"Z20			
42FFV4	2800	Φ160	1 3/8"Z6	182	30.5	Φ200
42FFV4D			1 3/8"Z21			
42FFV4C	2800	Φ160	1 3/4"Z6	189	30.5	Φ200
42FFV4E			1 3/4"Z20			

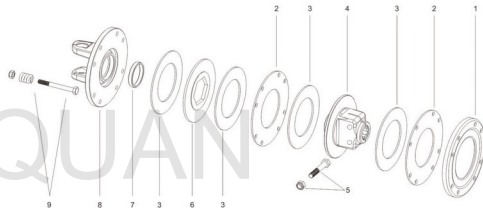

No.	Description	Notes
1	Pressure plate	
2	Internal disc	Qty.=2
3	Friction lining	Qty.=4
4	Hub	
5	Complete bolt	Qty.=2
6	Intermediate hub	
7	Bushing	
8	Flanged yoke	
9	Complete bolt&Spring	Qty.=8

FRICTION TORQUE LIMITER



Series	Max Torque(nm)	Friction Disc	Spline(female)	Spline(male)	A(mm)	B(mm)	C(mm)	D(mm)
FFS1	1200	Φ140	1 3/8"Z6	1 3/8"Z6	161.5	29	38	Φ180
FFS1D			1 3/8"Z21					
FFS2	1800	Φ160	1 3/8"Z6	1 3/8"Z6	161.5	29	38	Φ200
FFS2D			1 3/8"Z21					
FFS2C			1 3/8"Z6					
FFS2E			1 3/8"Z20					

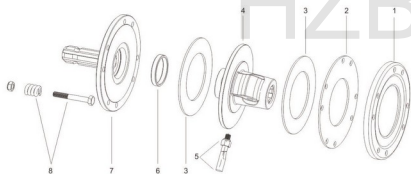

No.	Description	Notes
1	Pressure plate	
2	Internal disc	
3	Friction lining	Qty.=2
4	Hub	
5	Taper pin for hub	With nuts
6	Bushing	
7	Flanged spline	
8	Complete bolt & Spring	Qty.=8

FRICTION TORQUE LIMITER

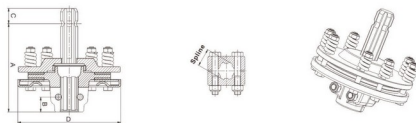

Series	Max Torque(nm)	Friction Disc	Spline(female)	Spline(male)	A(mm)	B(mm)	C(mm)	D(mm)
FFVS1	1200	Φ140	1 3/8"Z6	1 3/8"Z6	161.5	29	38	Φ180
FFVS1D	900		1 3/8"Z21					
FFVS2	1800	Φ160	1 3/8"Z6	1 3/8"Z6	161.5	29	38	Φ200
FFVS2D			1 3/8"Z21					
FFVS2C			1 3/8"Z6					
FFVS2E			1 3/8"Z20					

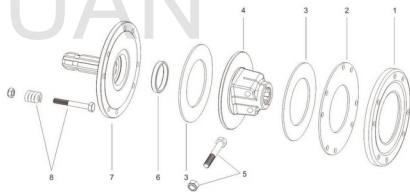

No.	Description	Notes
1	Pressure plate	
2	Internal disc	
3	Friction lining	Qty.=2
4	Hub	
5	Complete bolt	Qty.=2
6	Bushing	
7	Flanged spline	
8	Complete bolt & Spring	Qty.=8



Series	Max Torque(nm)	Friction Disc	Spline(female)	Spline(male)	A(mm)	B(mm)	C(mm)	D(mm)
FFS3	1500	Φ140	1 3/8"Z6	1 3/8"Z6	177	29	38	Φ180
FFS3D			1 3/8"Z21					
FFS4	2500	Φ160	1 3/8"Z6	1 3/8"Z6	177	29	38	Φ200
FFS4D			1 3/8"Z21					
FFS4C			1 3/8"Z6					
FFS4E			1 3/8"Z20					

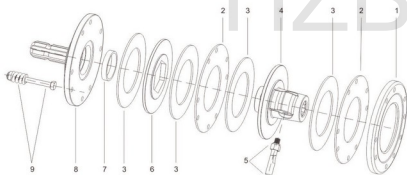

No.	Description	Notes
1	Pressure plate	
2	Internal disc	Qty.=2
3	Friction lining	Qty.=4
4	Hub	
5	Taper pin for hub	With nuts
6	Intermediate hub	
7	Bushing	
8	Flanged spline	
9	Complete bolt & Spring	Qty.=8



Series	Max Torque(nm)	Friction Disc	Spline(female)	Spline(male)	A(mm)	B(mm)	C(mm)	D(mm)
FFVS3	2000	Φ140	1 3/8"Z6	1 3/8"Z6	177	29	38	Φ180
FFVS3D			1 3/8"Z21					
FFVS4	2500	Φ160	1 3/8"Z6	1 3/8"Z6	177	29	38	Φ200
FFVS4D			1 3/8"Z21					
FFVS4C			1 3/8"Z6					
FFVS4E			1 3/8"Z20					

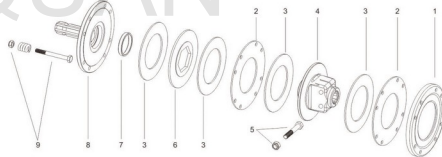

No.	Description	Notes
1	Pressure plate	
2	Internal disc	Qty.=2
3	Friction lining	Qty.=4
4	Hub	
5	Complete bolt	Qty.=2
6	Intermediate hub	
7	Bushing	
8	Flanged spline	
9	Complete bolt & Spring	Qty.=8

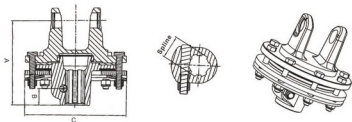

Series	Max Torque(nm)	Friction Disc	Spline	A(mm)	B(mm)	C(mm)
4FFT0	800	Φ120	1 3/8"Z6	150	29	Φ160
5FFT0			1 3/8"Z6	152		
4FFT1			1 3/8"Z6	150		
4FFT1D	900	Φ140	1 3/8"Z21	152	29	Φ180
5FFT1			1 3/8"Z21			
6FFT1			1 3/8"Z6	160		
6FFT1D			1 3/8"Z21			
5FFT2			1 3/8"Z6	152		
5FFT2D			1 3/8"Z21			
5FFT2C	1 3/4"Z6	164	29	Φ200		
5FFT2E	1 3/4"Z20					
6FFT2	1 3/8"Z6					
6FFT2D	1 3/8"Z21					
6FFT2C	1 3/4"Z6					
6FFT2E	1 3/4"Z20					
7FFT2	1 3/8"Z6				169	
7FFT2D	1 3/8"Z21					
7FFT2C	1 3/4"Z6					
7FFT2E	1 3/4"Z20					
7NFFT2	1 3/8"Z6	164	29	Φ200		
7NFFT2D	1 3/8"Z21					
7NFFT2C	1 3/4"Z6					
7NFFT2E	1 3/4"Z20					
8FFT2	1200	Φ160	1 3/8"Z6	169	29	Φ200
8FFT2D			1 3/8"Z21			
8FFT2C			1 3/4"Z6			
8FFT2E			1 3/4"Z20			

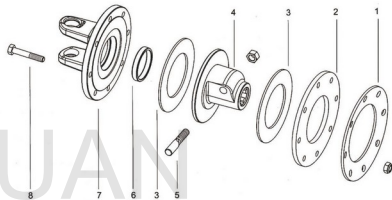

No.	Description	Notes
1	Belleville spring	
2	Pressure plate	
3	Friction discs	Qty.=2
4	Hub	
5	Taper pin for hub	With nuts
6	Bushing	
7	Flanged yoke	
8	Complete bolt	Qty.=8

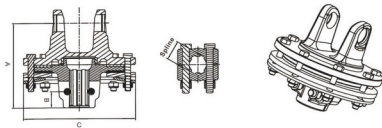

Series	Max Torque(nm)	Friction Disc	Spline	A(mm)	B(mm)	C(mm)			
4FFVT1	900	Φ140	1 3/8"Z6	150	29	Φ180			
4FFVT1D			1 3/8"Z21						
5FFVT1			1 3/8"Z6						
5FFVT1D			1 3/8"Z21						
6FFVT1			1 3/8"Z6						
6FFVT1D			1 3/8"Z21						
5FFVT1	1200	Φ160	1 3/8"Z6	152	29	Φ200			
5FFVT1D			1 3/8"Z21						
6FFVT1			1 3/8"Z6						
6FFVT1D			1 3/8"Z21						
6FFVT1			1 3/8"Z6						
6FFVT1D			1 3/8"Z21						
4FFVT2			1 3/8"Z6	143			160		
4FFVT2D			1 3/8"Z21						
5FFVT2			1 3/8"Z6	145				162	
5FFVT2D			1 3/8"Z21						
6FFVT2			1 3/8"Z6	153					163
6FFVT2D			1 3/8"Z21						
6FFVT2C	1 3/4"Z6	163	168						
6FFVT2E	1 3/4"Z20								
7FFVT2	1 3/8"Z6	162		168					
7FFVT2D	1 3/8"Z21								
7FFVT2C	1 3/4"Z6	168			162				
7FFVT2E	1 3/4"Z20								
8FFVT2	1 3/8"Z6	162	162						
8FFVT2D	1 3/8"Z21								
8FFVT2C	1 3/4"Z6	168		162					
8FFVT2E	1 3/4"Z20								

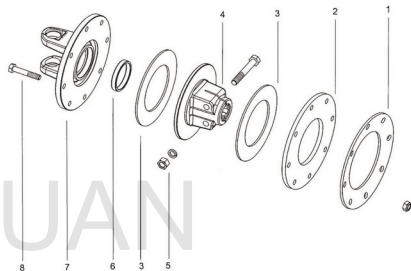

No.	Description	Notes
1	Belleville spring	
2	Pressure plate	
3	Friction discs	Qty.=2
4	Hub	
5	Complete bolt	Qty.=2
6	Bushing	
7	Flanged yoke	
8	Complete bolt	Qty.=8

FRICTION TORQUE LIMITER

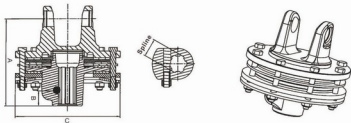

Series	Max Torque(nm)	Friction Disc	Spline	A(mm)	B(mm)	C(mm)
6FFT4	1600	Φ160	1 3/8"Z6	172	30.5	Φ200
6FFT4D			1 3/8"Z21			
6FFT4C			1 3/4"Z6			
6FFT4E			1 3/4"Z20			
7FFT4	2000	Φ160	1 3/8"Z6	177	30.5	Φ200
7FFT4D			1 3/8"Z21			
7FFT4C			1 3/4"Z6			
7FFT4E			1 3/4"Z20			
7NFFT4			1 3/8"Z6	172		
7NFFT4D			1 3/8"Z21			
7NFFT4C			1 3/4"Z6			
7NFFT4E			1 3/4"Z20			
8FFT4	177	184	1 3/8"Z6	177	184	
8FFT4D			1 3/8"Z21			
8FFT4C			1 3/4"Z6			
8FFT4E			1 3/4"Z20			

FRICTION TORQUE LIMITER

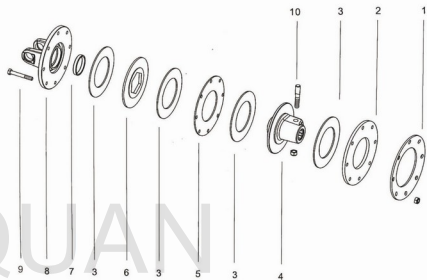

No.	Description	Notes
1	Belleville spring	
2	Pressure plate	
3	Friction discs	Qty.=4
4	Hub	
5	Pressure plate	
6	Hexagon board	
7	Bushing	
8	Flanged yoke	
9	Complete bolt	Qty.=8
10	Taper pin for hub	With nuts

FRICTION TORQUE LIMITER

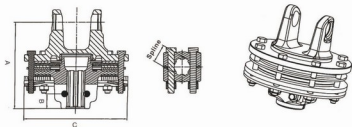

Series	Max Torque(nm)	Friction Disc	Spline	A(mm)	B(mm)	C(mm)
6FFVT4	1600	Φ160	1 3/8"Z6	175	29	Φ200
6FFVT4D			1 3/8"Z21			
6FFVT4C			1 3/4"Z6			
6FFVT4E			1 3/4"Z20			
7FFVT4	2000	Φ160	1 3/8"Z6	182	29	Φ200
7FFVT4D			1 3/8"Z21			
7FFVT4C			1 3/4"Z6			
7FFVT4E			1 3/4"Z20			
7NFFVT4			1 3/8"Z6	175		
7NFFVT4D			1 3/8"Z21			
7NFFVT4C			1 3/4"Z6			
7NFFVT4E			1 3/4"Z20			
8FFVT4	1 3/8"Z6	182				
8FFVT4D	1 3/8"Z21					
8FFVT4C	1 3/4"Z6					
8FFVT4E	1 3/4"Z20					

FRICTION TORQUE LIMITER

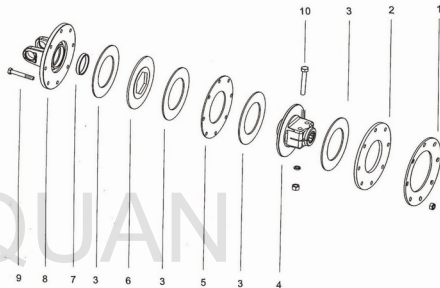

No.	Description	Notes
1	Belleville spring	
2	Pressure plate	
3	Friction discs	Qty.=4
4	Hub	
5	Pressure plate	
6	Hexagon board	
7	Bushing	
8	Flanged yoke	
9	Complete bolt	Qty.=8
10	Complete bolt	Qty.=2

FRICTION TORQUE LIMITER

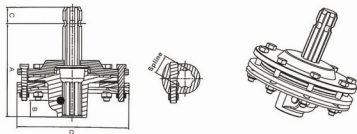

Series	Max Torque(nm)	Friction Disc	Spline(female)	Spline(male)	A(mm)	B(mm)	C(mm)	D(mm)
FFST1	900	Φ140	1 3/8"Z6	1 3/8"Z6	161.5	30.5	38	Φ180
FFST1D			1 3/8"Z21					
FFST2			1 3/8"Z6					
FFST2D	1200	Φ160	1 3/8"Z6	1 3/8"Z6	161.5	30.5	38	Φ200
FFST2C			1 3/4"Z6					
FFST2E			1 3/4"Z20					

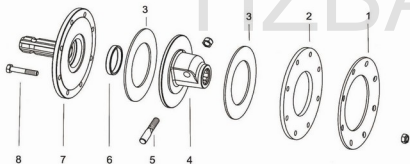

No.	Description	Notes
1	Belleville spring	
2	Pressure plate	
3	Friction discs	Qty.=2
4	Hub	
5	Taper pin sets	With nuts
6	Bushing	
7	Splined shaft welded assembly	
8	Complete bolt	Qty.=8

FRICTION TORQUE LIMITER

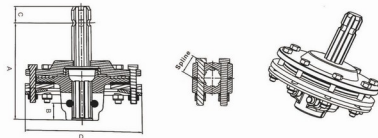

Series	Max Torque(nm)	Friction Disc	Spline(female)	Spline(male)	A(mm)	B(mm)	C(mm)	D(mm)
FFSVT1	900	Φ140	1 3/8"Z6	1 3/8"Z6	161.5	29	38	Φ180
FFSVT2			1 3/8"Z6					
FFSVT2D			1 3/8"Z21					
FFSVT2C	1200	Φ160	1 3/8"Z6	1 3/8"Z6	161.5	29	38	Φ200
FFSVT2E			1 3/4"Z6					
			1 3/4"Z20					

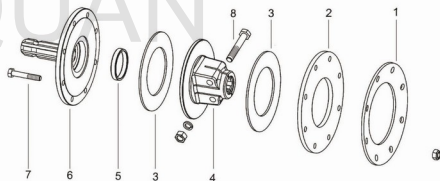

No.	Description	Notes
1	Belleville spring	
2	Pressure plate	
3	Friction discs	Qty.=2
4	Hub	
5	Bushing	With nuts
6	Splined shaft welded assembly	
7	Complete bolt	Qty.=8
8	Complete bolt	Qty.=2

FRICTION TORQUE LIMITER

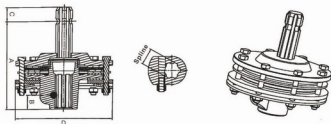

Series	Max Torque(nm)	Friction Disc	Spline(female)	Spline(male)	A(mm)	B(mm)	C(mm)	D(mm)
FFST3	900	Φ140	1 3/8"Z6					Φ180
FFST4			1 3/8"Z6					
FFST4D			1 3/8"Z21					
FFST4C	1200	Φ160	1 3/4"Z6	1 3/8"Z6	161.5	29	38	Φ200
FFST4E			1 3/4"Z20					

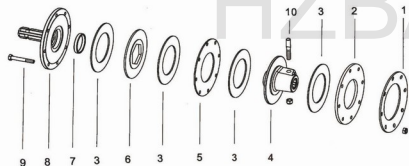

No.	Description	Notes
1	Belleville spring	
2	Pressure plate	
3	Friction discs	Qty.=4
4	Hub	
5	Pressure plate	
6	Hexagon board	
7	Bushing	
8	Spined shaft welded assembly	
9	Complete bolt	Qty.=8
10	Taper pin for hub	With nuts

FRICTION TORQUE LIMITER

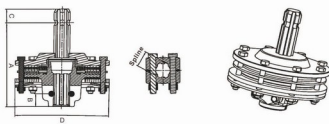

Series	Max Torque(nm)	Friction Disc	Spline(female)	Spline(male)	A(mm)	B(mm)	C(mm)	D(mm)
FFSVT3			1 3/8"Z6					
FFSVT3D	1200	Φ140	1 3/8"Z21	1 3/8"Z6	177	29	38	Φ180
FFSVT4			1 3/8"Z6					
FFSVT4D			1 3/8"Z21					
FFSVT4C	1200	Φ160	1 3/4"Z6	1 3/8"Z6	177	29	38	Φ180
FFSVT4E			1 3/4"Z20					

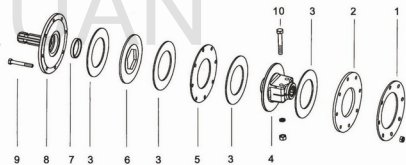

No.	Description	Notes
1	Belleville spring	
2	Pressure plate	
3	Friction discs	Qty.=4
4	Hub	
5	Pressure plate	
6	Hexagon board	
7	Bushing	
8	Spined shaft welded assembly	
9	Complete bolt	Qty.=8
10	Complete bolt	Qty.=2

FRICTION TORQUE LIMITER

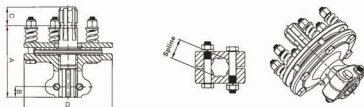

Series	Friction Disc	Disc Qty	Max Torque (nm)	Spline (female)	Spline (male)	A(mm)	B(mm)	C(mm)	D(mm)
FCS165	Φ125	2	800	1 3/8"Z6	1 3/8"Z6	140	20	35	Φ165
FCS165D	Φ125	2	800	1 3/8"Z21	1 3/8"Z6	140	20	35	Φ165

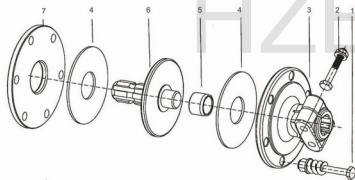

No.	Description	Notes
1	Complete bolt & Spring	Qty.=6
2	Complete bolt	Qty.=2
3	Hub with flange	
4	Friction disc	Qty.=2
5	Plastic bearing	
6	Flanged spline	
7	Pressure plate	

FRICTION TORQUE LIMITER

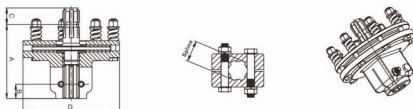



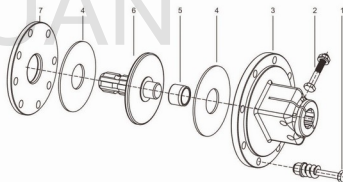

Series	Friction Disc	Disc Qty	Max Torque (nm)	Spline (female)	Spline (male)	A(mm)	B(mm)	C(mm)	D(mm)
FCS203	Φ163	2	1500	1 3/8"Z6	1 3/8"Z6	155.5	30	35	Φ203
FCS203D	Φ163	2	1500	1 3/8"Z21	1 3/8"Z6	155.5	30	35	Φ203



No.	Description	Notes
1	Complete bolt & Spring	Qty.=8
2	Complete bolt	Qty.=2
3	Hub with flange	
4	Friction disc	Qty.=2
5	Bushing	
6	Flanged spline	
7	Pressure plate	

PTO HUB&SPLINED SHAFT

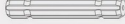
Name	Spline	Length(mm)	Drawings
00.20.A	1 1/8" Z6	60/65/80/100	
00.20.B	1 3/8" Z6	60/65/80/100	
00.20.C	1 3/4" Z6		
00.20.D	1 3/8" Z21	60/65/80/100	
00.20.E	1 3/4" Z20		

Name	Spline	Drawings	
00.19.A1	1 1/8" Z6		
00.19.B1	1 3/8" Z6		
00.19.C1	1 3/4" Z6		
00.19.D1	1 3/8" Z21		
00.19.E1	1 3/4" Z20		
00.19.A2	1 1/8" Z6		
00.19.B2	1 3/8" Z6		
00.19.C2	1 3/4" Z6		
00.19.D2	1 3/8" Z21		
00.19.E2	1 3/4" Z20		
00.19.BT			
00.19.BT1	1 3/8" Z6		
00.19.BT2			
00.19.GT			
00.19.GT1	8-32X38X6		
00.19.GT2			

INDUSTRIAL CARDAN SHAFT SERIES

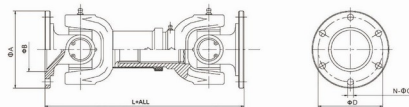

No.	L+ALL	A(mm)	B(mm)	C(mm)	D(mm)	Cross
1	L+ALL	58	30	4-5.00	47	Φ18X47
2		65	35	4-6.00	52	Φ20X50
3		75	42	6-6.00	62	Φ23.8X61.3
4		90	47	4-8.00	74.5	Φ27X74.6
5		100	57	4-8.00	79.4	Φ27X81.8
6		100	57	6-8.00	84	Φ30X81.8
7		120	75	8-10.00	101.5	Φ35X97
8		120	75	8-12.00	130	Φ39.68X115.7
9		150	90	8-12.00	130	Φ42/48X115.7
10		150	90	8-12.00	130	Φ45X123
11		150/165	90	8-14.00	140	Φ52X133
12		180	110	10-16.00	155	Φ57X153

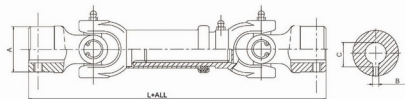

No.	L+ALL	A(mm)	B(mm)	C(mm)	Cross
1	L+ALL	43/44	8	22.8	Φ18x47
2		55/57		33.3	Φ23.8x61.3
3		55/57		38.7	Φ30x81.8

PB-D22-12D-79

Series
Double
Outer Diameter

Length
End hub Configuration
Inside Diameter

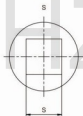
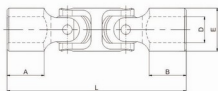
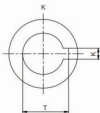

Series	D(h7)	E	L	A	B	K(js9)	T	S(h8)	Sw(h8)
PB-D20	10	20	74	11.5	22.5	3	11.4	10	10
PB-D22	12	22	79	14	25	4	13.8	12	12
PB-D25	14	25	89	15	28	5	16.3	14	14
PB-D29	16	29	100	18	32.5	5	18.3	16	16
PB-D32	18	32	111	19	36	6	20.8	18	18
PB-D35	20	35	120	21.5	39	6	22.8	20	20
PB-D37	20	37	128	21	41	6	22.8	20	20
PB-D40	22	40	145	25.5	47.5	6	24.8	22	22
PB-D45	25	45	163	31	54	8	28.3	25	25
PB-D50	30	50	185	35	61	8	33.3	30	30
PB-D60	35	60	232	49	80	10	38.3	35	35
PB-D70	40	70	225	33.5	70	12	43.3		
PB-D80	45	80	260	38	80	14	48.8		
PB-D95	50	95	310	45	95	14	53.8		

PB-S16-8D-40

Series
Single
Outer Diameter

Length
End hub Configuration
Inside Diameter

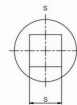
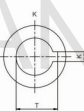
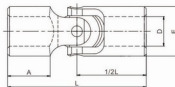

Series	D(h7)	E	L	A	B	K(js9)	T	S(h8)	Sw(h8)
PB-S13	6	13	40	13	20				
PB-S16	8	16	40	11	20	2	9	8	8
PB-S20	10	20	45	11.5	22.5	3	11.4	10	10
PB-S22	12	22	50	14	25	4	13.8	12	12
PB-S25	14	25	56	15	28	5	16.3	14	14
PB-S29	16	29	65	18	32.5	5	18.3	16	16
PB-S32	18	32	72	19	36	6	20.8	18	18
PB-S35	20	35	78	21.5	39	6	22.8	20	20
PB-S37	20	37	82	21	41	6	22.8	20	20
PB-S40	22	40	95	25.5	47.5	6	24.8	22	22
PB-S45	25	45	108	31	54	8	28.3	25	25
PB-S50	30	50	122	35	61	8	33.3	30	30
PB-S60	35	60	160	49	80	10	38.3	35	35
PB-S70	40	70	140	33.5	70	12	43.3		
PB-S80	45	80	160	38	80	14	48.8		
PB-S95	50	95	190	45	95	14	53.8		